

# Table of Contents

## PRESSURE GAUGES



### Pressure Gauges

Design & Operation

4

### Process Gauges

Solid front, blow-out back safety gauges well suited for most process requirements.



#### 450 Series

6

Solid Front • Field Liquid Fillable • Turret Case

#### 750 Series

8

Solid Front • Field Liquid Fillable • Stainless Steel Case

### Industrial Gauges

Accurate and durable gauges for a broad spectrum of industrial needs.



#### 500X Series

10

Dial Sizes thru 12" • Cast Aluminum Case

#### 700 Series

12

Field Liquid Fillable • Stainless Steel Case

### Commercial & Contractor Gauges

Compact and dependable gauges used by construction and HVAC industries.



#### 600CB Cast Aluminum Case

14

#### 610CB Glass Filled Nylon Case

16

#### 620B Stainless Steel Case

18

#### 690 Series Multiple Stainless Steel Case Styles

20

### Utility Gauges

Economically priced gauges suited for a variety of general applications.



#### D80 Series Dry or Liquid Filled • Stainless Steel Case

22

#### 800B Dry • Black Finished Steel Case

24

#### 800LFB Liquid Filled • Plastic Case

26

# Table of Contents

## PRESSURE GAUGES

### Specialty Gauges

Products designed to meet the needs of specialized industrial markets; including low-pressure gas, sanitary and remote reading applications.



**760B** 28

Low Pressure Gauge • Black Finished Steel Case



**766SS** 30

Low Pressure Gauge • Stainless Steel Case



**700TA** 32

Sanitary Gauge with Integrated Diaphragm Seal



**700Plus** 34

Industrial Transmitter Gauge

Special Application Ranges 36-38

### Pressure Gauge Options & Accessories

Enhancements to customize and optimize pressure gauge performance, along with the necessary accessories to complete any installation.

Optional Case Styles 40-50

Optional Features 51-54

Accessories 55-58

### Diaphragm Seals

Protective devices that isolate a pressure sensing instrument from the process fluid being monitored. Especially useful when measuring corrosive or viscous pressure mediums.



Design & Operation 60-63

**Threaded-NPT** 64

**Flange-Mounted** 66

**In-line Threaded** 68

**Saddle-Welded** 70

**Drop-in Welded** 72

**Mini & Compact** 74

**Sanitary** 76

Options & Accessories 78-79

PRESSURE GAUGES

# Pressure Gauges

## DESIGN & OPERATION

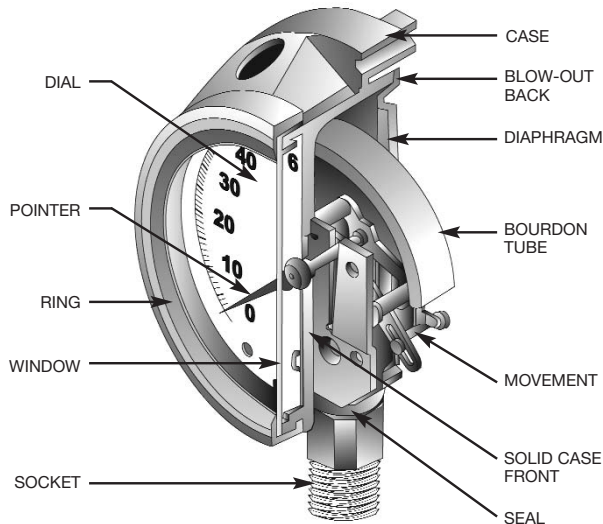

### Description

A pressure gauge is a mechanical instrument designed to measure the internal pressure and/or vacuum of a vessel or system. Trerice Pressure Gauges are offered in a variety of styles, sizes, and wetted part materials to meet the demands of standard and special applications.

### Principles of Operation

Most Trerice Pressure Gauges are constructed with a bourdon tube sensing element. When the sensing element is subjected to pressure, it flexes and the resulting motion is transmitted as a measurement through a mechanical movement to the dial face pointer.

## Selecting a Pressure Gauge

### Case

Cases are available in a wide variety of materials and configurations. The combination of material and configuration is generally determined by the demands of the application, as well as the preferences of the gauge specifier. The more demanding the environment, the more rugged the case construction (i.e., polypropylene or stainless steel for industrial applications vs. aluminum or steel for construction or commercial applications). Gauge mounting or retrofitting needs may affect case selection (i.e., a gauge to be panel mounted will require either a front flange or u-clamp style case). For safety considerations, a "solid-front" case style may be required. Each application will have a unique set of requirements which will help guide the specifier in selecting the appropriate case style.

**All Trerice Pressure Gauges should be carefully selected to meet the demands of the particular application. The information contained in this catalog is only offered as a guide to assist in making the proper selection.**

**Improper application may cause failure of the gauge, resulting in possible personal injury or property damage. For correct use and application of all pressure gauges, please refer to Pressure Gauge Standard ASME B40.100. This document may be obtained from the American Society of Mechanical Engineers (ASME), Three Park Avenue, New York, NY 10016-5990.**

### Wetted Parts and Pressure Medium

Under normal operating conditions, only the tube and socket assembly (Wetted Parts) of a pressure gauge will come into contact with the fluid being measured (Pressure Medium). The selection of the assembly will be determined by the composition of the medium. Air, gas, steam, water and other noncorrosive media are usually satisfied by a bronze or brass bourdon tube and brass socket assembly. Stainless steel or Monel wetted parts are used when the medium contains corrosive elements or when high operating pressures or temperatures will be encountered. A diaphragm seal is recommended for highly corrosive media or that which may solidify or deposit solids within the tube and socket assembly of the gauge. (See the Diaphragm Seal section of this catalog.)

## Connection and Mounting

The socket connection provides an entrance port for the process medium as well as a means to mount the gauge to a pipeline or vessel. Male connections can be provided with NPT, BSPT, or other thread styles, in sizes from 1/8" through 1/2". A high-pressure, 9/16" LHT connection is also available. The mounting location indicates where the connection protrudes from the case. Terice Pressure Gauges are available with three standard mounting locations: lower male (LM), lower back male (LBM), and center back male (CBM). Other connection locations may be available on some models.

## Window and Ring

The window provides a means for viewing the measurement, as well as protection of the dial face and pointer of the instrument, and is normally held in place by a ring, which is screwed or snapped to the case of the gauge. Plastic, clear glass and laminated glass are common window materials. Ring styles include threaded, bayonet, friction, crimped and hinged, depending upon the case type.

## Pointer

There are essentially three types of pointers available on Terice Pressure Gauges: a micro-adjustable pointer (providing high quality and accuracy); a friction-type pointer (providing adjustability and durability); and a plain, non-adjustable pointer (providing economic reliability).

## Accuracy

The accuracy of a pressure gauge is expressed as a percentage (plus or minus) of the maximum scale range. Please refer to Pressure Gauge Standard ASME B40.100.

## Measurement Range and Dial

The maximum operating pressure of the application should not exceed 75% of the measurement range selected. Therefore, the specified range should be twice the normal operating point of the gauge to avoid damage to the gauge internal. A wide variety of measurement ranges is available, from 30" Hg vacuum through 20,000 psi pressure. Ranges are indelibly presented in black figures and markings upon a white dial face.

During system start-up or shut-down, system pressures can greatly exceed intended conditions. Pressure gauges should be protected by appropriate isolation devices such as, but not limited to, needle valves, gauge cocks, etc.

## Environmental Conditions

Pressure gauge selection will be influenced by the environmental conditions under which the gauge is expected to perform. Condensation or waterproofing concerns can be addressed through the use of hermetically sealed or weatherproofed gauges. Case construction should be considered when selecting a gauge to be used in conditions of extreme or sustained heat or cold, or where the atmospheric environment may contain corrosive elements.

Pressure gauges provide an excellent and reliable means of measuring and indicating process conditions, however they are passive devices. They are not substitutes for active safety devices. For start-up or test situations on closed loop systems, a safety relief device must be used.

## Liquid Filling

Liquid filling (glycerin, silicone or other fills) can prolong the life of a pressure gauge by minimizing wear on the gauge internal resulting from vibration or oscillation. Liquid filling also acts as a permanent lubricant to the moving parts of the instrument.

# 450 Series

Solid Front • Field Liquid Fillable • Turret Case

PROCESS GAUGES



450B shown

- ▶ 4 1/2" Dial Size
- ▶ ±0.5% Accuracy
- ▶ Solid Front/Blow-Out Back
- ▶ Field Liquid Fillable

The Trerice **450 Series** Process Gauge is designed for the petrochemical and industrial process industries. This solid front, blow-out back gauge is noted for its fiberglass reinforced polypropylene turret case and screwed ring; its sturdy interior design; and its field liquid-fill capability (no kit required). The 450 Series can withstand the most rugged industrial applications, while maintaining precise accuracy. Wetted parts are bronze tube/brass socket, stainless steel, or Monel.

- Optional features available: Please consult the Options & Accessories Section for details.
- For correct use and application of all pressure gauges, please refer to: Pressure Gauge Standard ASME B40.100.

## Specifications

Models	Wetted Parts
450B (dry)	Bronze tube, brass socket
450LFB (liquid-filled)	
450SS (dry)	316 stainless steel* tube and socket
450LFSS (liquid-filled)	
450M (dry)	Monel tube and socket (meets NACE MR 01.75)
450LFM (liquid-filled)	

Dial Size	4 1/2"
Fill	Glycerine. Other fills available. See Options & Accessories
Movement	Stainless steel
Connection	Lower male or lower back male, 1/4 or 1/2 NPT
Case	Fiberglass reinforced polypropylene, turret, solid front with blow-out back
Ring	Threaded fiberglass reinforced polypropylene
Window	Acrylic
Pointer	Micro adjustable, black finished
Dial Face	Aluminum, white background with black graduations and markings

<b>Additional Features</b> Overload and underload stops	
Accuracy	±0.5% Full Scale, ASME B40.100 Grade 2A
Maximum Temperature	450B, 450SS, 450M: 250°F (121°C) 450LFB, 450LFSS, 450LFM: 150°F (65°C)
Approximate Shipping Weight	450B, 450SS, 450M: 2.2 lbs [1.00 kg] 450LFB, 450LFSS, 450LFM: 3.1 lbs [1.41 kg]

\* Ranges over 10,000 PSI have Ni-Span-C tube.

## HOW TO ORDER

Sample Order Number: **450LFB 45 02 L D 110**

Model	Dial Size	Connection Size	Connection Location	Units of Measure	Range Code
450B 450LFB 450SS 450LFSS 450M 450LFM	45 4 1/2"	02 1/4 NPT 04 1/2 NPT	L Lower B Back	A psi B kPa C kg/cm <sup>2</sup> D psi/kPa E psi & kg/cm <sup>2</sup>	See Standard Ranges

# 450 Series

All dimensions are nominal. Dimensions in [ ] are in millimeters.

**Solid Front • Field Liquid Fillable • Turret Case**

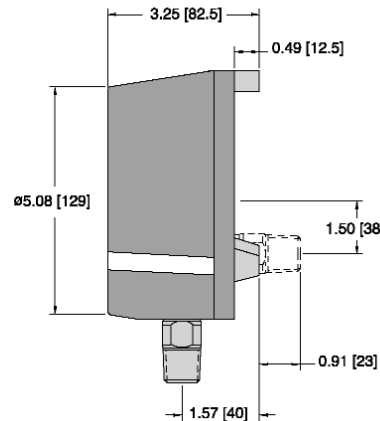
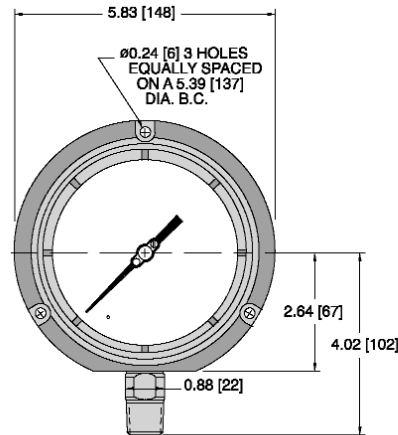

PROCESS GAUGES

## Standard Ranges

psi Ranges (A)				kPa Ranges (B)				kg/cm <sup>2</sup> Ranges (C)			
Range Code	Specific Range (psi)	Figure Intervals	Minor Divisions	Range Code	Specific Range	Figure Intervals	Minor Divisions	Range Code	Specific Range	Figure Intervals	Minor Divisions
010	30" Hg to 0	5	0.2	010	-100 to 0 kPa	10	1	010	76 cm Hg to 0	10	0.5
020	30" Hg to 15 psi	5/5	0.5/0.2	020	-100 to 100 kPa	20	2	020	76 cm Hg to 1 kg/cm <sup>2</sup>	20/0.2	1/0.2
030	30" Hg to 30 psi	10/5	1/0.5	030	-100 to 200 kPa	50	2	030	76 cm Hg to 2 kg/cm <sup>2</sup>	20/0.5	2/0.2
040	30" Hg to 60 psi	10/10	1/1	040	-100 to 400 kPa	50	5	040	76 cm Hg to 4 kg/cm <sup>2</sup>	25/0.5	5/0.5
050	30" Hg to 100 psi	30/10	2/1	050	-100 to 600 kPa	100	5	050	76 cm Hg to 7 kg/cm <sup>2</sup>	76/1	5/0.1
060	30" Hg to 150 psi	30/20	5/2	060	-100 to 1000 kPa	100	10	060	76 cm Hg to 10 kg/cm <sup>2</sup>	76/1	15/0.1
070	30" Hg to 300 psi	30/50	5/2	070	-100 to 2000 kPa	200	20	070	76 cm Hg to 21 kg/cm <sup>2</sup>	76/2	19/0.2
080	0 to 15 psi	3	0.1	080	0 to 100 kPa	10	1	080	0 to 1 kg/cm <sup>2</sup>	0.1	0.01
090	0 to 30 psi	5	0.2	090	0 to 200 kPa	20	2	090	0 to 2 kg/cm <sup>2</sup>	0.2	0.02
100	0 to 60 psi	10	0.5	100	0 to 400 kPa	50	5	100	0 to 4.2 kg/cm <sup>2</sup>	0.5	0.05
110	0 to 100 psi	10	1	110	0 to 700 kPa	100	5	110	0 to 7 kg/cm <sup>2</sup>	1	0.05
120	0 to 160 psi	20	1	120	0 to 1200 kPa	200	10	120	0 to 11 kg/cm <sup>2</sup>	1	0.1
130	0 to 200 psi	20	2	130	0 to 1500 kPa	300	10	130	0 to 14 kg/cm <sup>2</sup>	2	0.1
140	0 to 300 psi	50	2	140	0 to 2000 kPa	200	20	140	0 to 21 kg/cm <sup>2</sup>	3	0.2
150	0 to 400 psi	50	5	150	0 to 3000 kPa	300	20	150	0 to 28 kg/cm <sup>2</sup>	4	0.2
160	0 to 600 psi	50	5	160	0 to 4000 kPa	500	50	160	0 to 42 kg/cm <sup>2</sup>	6	0.5
180	0 to 1000 psi	100	10	180	0 to 7000 kPa	1000	50	180	0 to 70 kg/cm <sup>2</sup>	10	0.5
Ranges over 1000 psi are not available on 450B and 450LFB.											
190	0 to 1500 psi	300	10	190	0 to 10,000 kPa	1000	100	190	0 to 100 kg/cm <sup>2</sup>	10	1
200	0 to 2000 psi	200	20	200	0 to 14,000 kPa	2000	100	200	0 to 140 kg/cm <sup>2</sup>	20	1
210	0 to 3000 psi	300	20	210	0 to 20,000 kPa	2000	200	210	0 to 210 kg/cm <sup>2</sup>	30	2
220	0 to 5000 psi	500	50	220	0 to 35,000 kPa	5000	250	220	0 to 350 kg/cm <sup>2</sup>	50	2
230	0 to 10,000 psi	1000	100	230	0 to 60,000 kPa	10,000	500	230	0 to 700 kg/cm <sup>2</sup>	100	10
Ranges over 10,000 psi are only available on 450SS and 450LFSS, and have Ni-Span-C tubes.											
240	0 to 15,000 psi	2000	100	240	0 to 100,000 kPa	20,000	1000	240	0 to 1000 kg/cm <sup>2</sup>	100	10
250	0 to 20,000 psi	2000	200	250	0 to 140,000 kPa	20,000	1000	250	0 to 1400 kg/cm <sup>2</sup>	200	20

For dual scale ranges, specify the appropriate **Units of Measure: D (psi/kPa) or E (psi & kg/cm<sup>2</sup>)** followed by the equivalent **A (psi) Range Code**. Other pressure ranges are also available including: Altitude, Ammonia, Refrigerant and Receiver. Consult Special Application Ranges section or factory for availability.



# 750 Series

Solid Front • Field Liquid Fillable • Stainless Steel Case

PROCESS GAUGES



750SS shown



- ▶ 4" Dial Size
- ▶  $\pm 1.0\%$  Accuracy
- ▶ Stainless Steel Case
- ▶ Solid Front/Blow-Out Back
- ▶ Field Liquid Fillable

The Trerice **750 Series** Process Gauge is designed for the varying needs of the world's process industries. This solid front/blow-out back gauge features a stainless steel case and ring. Its sturdy interior design and field liquid-fill capability (no kit required) provide the durability, accuracy and safety required for industrial process applications. Wetted parts are stainless steel or Monel.

- Optional features available: Please consult the Options & Accessories Section for details.
- For correct use and application of all pressure gauges, please refer to: Pressure Gauge Standard ASME B40.100.

## Specifications

Models	Wetted Parts
750SS (dry)	316 stainless steel tube and socket
750LFSS (liquid-filled)	
750M (dry)	Monel tube and socket (meets NACE MR 01.75)
750LFM (liquid-filled)	
Dial Size	4"
Fill	Glycerine. Other fills available. See Options & Accessories.
Movement	Stainless steel
Connection	Lower male, 1/4 or 1/2 NPT
Case	304 stainless steel, satin finished, stem-mounted flangeless, solid front with blow-out back
Ring	Bayonet type, 304 stainless steel
Window	Laminated safety glass
Pointer	Plain, black finished
Dial Face	Aluminum, white background with black graduations and markings
Accuracy	$\pm 1.0\%$ Full Scale, ASME B40.100 Grade 1A
<b>Maximum Temperature</b> 750SS, 750M: <b>250°F (121°C)</b> 750LFSS, 750LFM: <b>150°F (65°C)</b>	
<b>Approximate Shipping Weight</b> 750SS, 750M: 1.3 lbs [0.59 kg] 750LFSS, 750LFM: 1.8 lbs [0.82 kg]	

## HOW TO ORDER

Sample Order Number: **750SS 40 04 L D 120**

Model	Dial Size	Connection Size	Connection Location	Units of Measure	Range Code
750SS 750LFSS 750M 750LFM	40 4"	02 1/4 NPT 04 1/2 NPT	L Lower	A psi D psi/kPa	See Standard Ranges

# 750 Series

All dimensions are nominal.  
Dimensions in [ ] are in millimeters

**Solid Front • Field Liquid Fillable • Stainless Steel Case**

PROCESS GAUGES

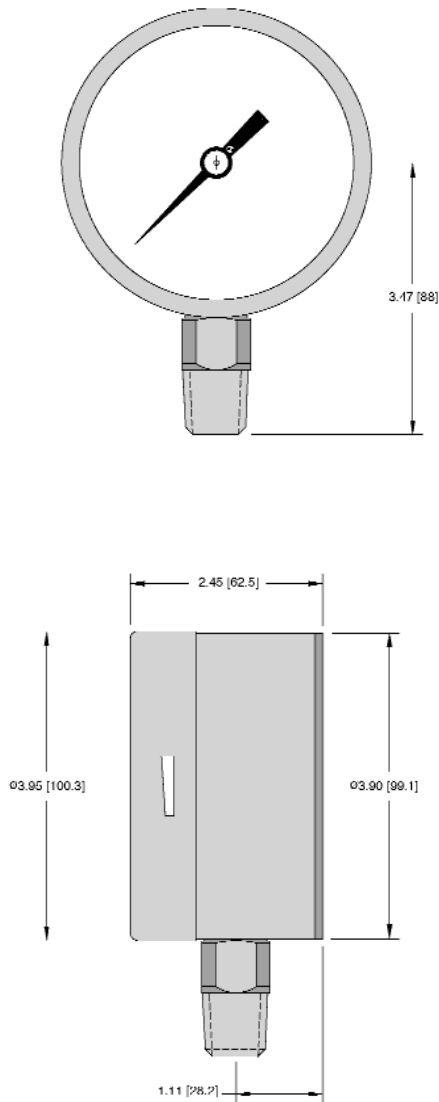

## Standard Ranges

psi Ranges (A)			
Range Code	Specific Range (psi)	Figure Intervals	Minor Divisions
010	30" Hg to 0	5	0.5
020	30" Hg to 15 psi	10/5	0.5/0.5
030	30" Hg to 30 psi	10/5	1/1
040	30" Hg to 60 psi	10/10	2/1
050	30" Hg to 100 psi	30/20	2/2
060	30" Hg to 150 psi	30/20	5/2
070	30" Hg to 300 psi	30/50	5/5
080	0 to 15 psi	3	0.2
090	0 to 30 psi	5	0.5
100	0 to 60 psi	10	1
110	0 to 100 psi	10	2
120	0 to 160 psi	20	2
130	0 to 200 psi	20	2
140	0 to 300 psi	50	5
150	0 to 400 psi	50	5
160	0 to 600 psi	100	10
180	0 to 1000 psi	100	20
190	0 to 1500 psi	300	20
200	0 to 2000 psi	200	20
210	0 to 3000 psi	500	50
220	0 to 5000 psi	1000	100
230	0 to 10,000 psi	2000	200
Ranges over 10,000 psi are ONLY available on 750SS or 750LFSS.			
240	0 to 15,000 psi	2000	200
250	0 to 20,000 psi	2000	200

For dual scale ranges, specify the appropriate **Units of Measure: D** (psi/kPa) followed by the corresponding **A** (psi) **Range Code**. Other pressure ranges are also available including: Altitude, Ammonia, Refrigerant and Receiver. Consult Special Application Ranges section or factory for availability.



# 500X Series

Dial Sizes thru 12" • Cast Aluminum Case

INDUSTRIAL GAUGES



500XB shown



- ▶ 4 1/2", 6", 8 1/2", 12" Dial Sizes
- ▶ ±0.5% Accuracy
- ▶ Cast Aluminum Case

The Trerice **500X Series** Industrial Gauge is designed to withstand the most demanding applications of a variety of industries. This pressure gauge has a back flanged, cast aluminum case and stainless steel ring. Wetted parts are either bronze tube with brass socket or stainless steel tube and socket.

- Optional features and case style variations available: Please consult the Options & Accessories Section for details.
- For correct use and application of all pressure gauges, please refer to: Pressure Gauge Standard ASME B40.100.

## Specifications

Models	Wetted Parts
<b>500XB</b>	Bronze tube, brass socket
<b>500XSS</b>	316 stainless steel tube and socket *
<b>Dial Sizes</b>	4 1/2", 6", 8 1/2", 12"
<b>Movement</b>	Stainless steel
<b>Connection</b>	Lower male or lower back male, 1/4 or 1/2 NPT
<b>Case</b>	Cast aluminum, black finished, surface mounted back flanged
<b>Ring</b>	4 1/2", 6", 8 1/2" Dial Size: Friction type, 304 stainless steel  12" Dial Size: Friction type, steel, black finished
<b>Window</b>	Clear glass
<b>Pointer</b>	4 1/2", 6", 8 1/2" Dial Size: Micro adjustable, black finished,  12" Dial Size: Plain, black finished
<b>Dial Face</b>	Aluminum, white background with black graduations and markings
<b>Accuracy</b>	±0.5% Full Scale, ASME B40.100 Grade 2A
<b>Maximum Temperature</b> <b>250°F (121°C)</b>	
<b>Approximate Shipping Weight</b>	
4 1/2" Dial Size: 2.0 lbs [0.91 kg]	
6" Dial Size: 2.8 lbs [1.27 kg]	
8 1/2" Dial Size: 5.8 lbs [2.63 kg]	
12" Dial Size: 14.6 lbs [6.62 kg]	

\* Ni-Span C tube and 316 stainless steel socket furnished above 10,000 psi.

## HOW TO ORDER

Sample Order Number: **500XB 45 02 L A 110**

Model	Dial Size	Connection Size	Connection Location	Units of Measure	Range Code
<b>500XB</b>	<b>45</b> 4 1/2"	<b>02</b> 1/4 NPT	<b>L</b> Lower	<b>A</b> psi	See Standard Ranges
<b>500XSS</b>	<b>60</b> 6"	<b>04</b> 1/2 NPT	<b>B</b> Back	<b>B</b> kPa	
	<b>85</b> 8 1/2"			<b>C</b> kg/cm <sup>2</sup>	
	<b>12</b> 12"			<b>D</b> psi/kPa	
				<b>E</b> psi & kg/cm <sup>2</sup>	

# 500X Series

## Dial Sizes thru 12" • Cast Aluminum Case

All dimensions are nominal. Dimensions in [ ] are in millimeters.

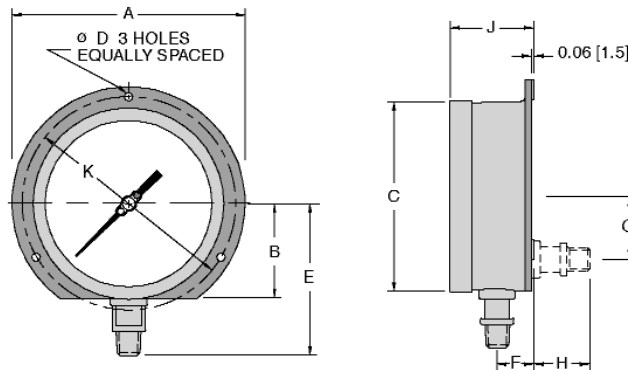

Dial Size	A	B	C	D	E	F	G	H	J	K
4 1/2"	5.88 [149.7]	2.39 [60.7]	4.79 [121.7]	0.22 [5.6]	3.83 [97.2]	0.94 [23.8]	1.63 [41.3]	1.41 [35.7]	2.06 [52.4]	5.38 [136.5]
6"	7.62 [193.6]	3.14 [79.8]	6.29 [159.8]	0.28 [7.1]	4.70 [119.5]	0.93 [23.8]	1.63 [41.3]	1.41 [35.7]	2.09 [53]	7.00 [177.8]
8 1/2"	10.25 [260.4]	4.38 [111.1]	8.80 [223.4]	0.28 [7.1]	5.81 [147.5]	0.97 [24.6]	1.63 [41.3]	1.41 [35.7]	2.24 [56.8]	9.63 [244.5]
12"	14.25 [362]	N/A	12.66 [321.5]	0.28 [7.1]	7.90 [200.7]	1.02 [25.9]	1.63 [41.3]	1.19 [30.2]	2.53 [64.3]	13.50 [343]

### Standard Ranges

psi Ranges (A)				kPa Ranges (B)				kg/cm <sup>2</sup> Ranges (C)			
Range Code	Specific Range (psi)	Figure Intervals	Minor Divisions	Range Code	Specific Range	Figure Intervals	Minor Divisions	Range Code	Specific Range	Figure Intervals	Minor Divisions
010	30" Hg to 0	5	0.2	010	-100 to 0 kPa	10	1	010	76 cm Hg to 0	10	0.5
020	30" Hg to 15 psi	5/5	0.5/0.2	020	-100 to 100 kPa	20	2	020	76 cm Hg to 1 kg/cm <sup>2</sup>	20/0.2	1/0.2
030	30" Hg to 30 psi	10/5	1/0.5	030	-100 to 200 kPa	50	2	030	76 cm Hg to 2 kg/cm <sup>2</sup>	20/0.5	2/0.2
040	30" Hg to 60 psi	10/10	1/1	040	-100 to 400 kPa	50	5	040	76 cm Hg to 4 kg/cm <sup>2</sup>	25/0.5	5/0.5
050	30" Hg to 100 psi	30/10	2/1	050	-100 to 700 kPa	100	5	050	76 cm Hg to 7 kg/cm <sup>2</sup>	76/1	5/0.1
060	30" Hg to 150 psi	30/20	5/2	060	-100 to 1000 kPa	100	10	060	76 cm Hg to 10 kg/cm <sup>2</sup>	76/1	15/0.1
070	30" Hg to 300 psi	30/50	5/2	070	-100 to 2000 kPa	200	20	070	76 cm Hg to 21 kg/cm <sup>2</sup>	76/2	19/0.2
080	0 to 15 psi	3	0.1	080	0 to 100 kPa	10	1	080	0 to 1 kg/cm <sup>2</sup>	0.1	0.01
090	0 to 30 psi	5	0.2	090	0 to 200 kPa	20	2	090	0 to 2 kg/cm <sup>2</sup>	0.2	0.02
100	0 to 60 psi	10	0.5	100	0 to 400 kPa	50	5	100	0 to 4.2 kg/cm <sup>2</sup>	0.5	0.5
110	0 to 100 psi	10	1	110	0 to 700 kPa	100	5	110	0 to 7 kg/cm <sup>2</sup>	1	0.5
120	0 to 160 psi	20	1	120	0 to 1200 kPa	200	10	120	0 to 11 kg/cm <sup>2</sup>	1	0.1
130	0 to 200 psi	20	2	130	0 to 1500 kPa	300	10	130	0 to 14 kg/cm <sup>2</sup>	2	0.1
140	0 to 300 psi	50	2	140	0 to 2000 kPa	200	20	140	0 to 21 kg/cm <sup>2</sup>	3	0.2
150	0 to 400 psi	50	5	150	0 to 3000 kPa	300	20	150	0 to 28 kg/cm <sup>2</sup>	4	0.2
160	0 to 600 psi	50	5	160	0 to 4000 kPa	500	50	160	0 to 42 kg/cm <sup>2</sup>	6	0.5
180	0 to 1000 psi	100	10	180	0 to 7000 kPa	1000	50	180	0 to 70 kg/cm <sup>2</sup>	10	0.5
Ranges over 1000 psi are not available on 500XB.											
190	0 to 1500 psi	300	10	190	0 to 10,000 kPa	1000	100	190	0 to 100 kg/cm <sup>2</sup>	10	1
200	0 to 2000 psi	200	20	200	0 to 14,000 kPa	2000	100	200	0 to 140 kg/cm <sup>2</sup>	20	1
210	0 to 3000 psi	300	20	210	0 to 20,000 kPa	2000	200	210	0 to 210 kg/cm <sup>2</sup>	30	2
220	0 to 5000 psi	500	50	220	0 to 35,000 kPa	5000	250	220	0 to 350 kg/cm <sup>2</sup>	50	2
230	0 to 10,000 psi	1000	100	230	0 to 60,000 kPa	10,000	500	230	0 to 700 kg/cm <sup>2</sup>	100	10
240	0 to 15,000 psi	2000	100	240	0 to 100,000 kPa	20,000	1000	240	0 to 1000 kg/cm <sup>2</sup>	100	10
250	0 to 20,000 psi	2000	200	250	0 to 140,000 kPa	20,000	1000	250	0 to 1400 kg/cm <sup>2</sup>	200	20

For dual scale ranges, specify the appropriate **Units of Measure: D (psi/kPa) or E (psi & kg/cm<sup>2</sup>)** followed by the equivalent **A (psi) Range Code**. Other pressure ranges are also available including: Altitude, Ammonia, Refrigerant and Receiver. Consult Special Application Ranges section or factory for availability.

# 600CB

## Cast Aluminum Case

COMMERCIAL • CONTRACTOR GAUGES



600CB shown



▶ 3 1/2" & 4 1/2" Dial Sizes

▶ ±1.0% Accuracy

▶ Cast Aluminum Case

▶ Adjustable Pointer

The **600CB** Trerice Contractor Gauge is among the most frequently specified HVACR gauges within the construction industry. This gauge offers high reliability at a moderate price. The 600CB is furnished with a cast aluminum case and an adjustable pointer.

- Optional features and case style variations available: Please consult the Options & Accessories Section for details.

- For correct use and application of all pressure gauges, please refer to: Pressure Gauge Standard ASME B40.100.

### Specifications

#### Model

600CB

**Dial Sizes** 3 1/2", 4 1/2"

#### Wetted Parts

3 1/2" Dial Size:  
Bronze tube, brass socket  
4 1/2" Dial Size:  
Brass tube & socket

**Movement** Brass

**Connection** Lower male, 1/4 NPT

**Case** Cast aluminum, black finished, stem-mounted flangeless

**Ring** 3 1/2" Dial Size: Friction type, steel, black finished  
4 1/2" Dial Size: Friction type, 304 stainless steel

**Window** Clear glass

**Pointer** Adjustable, black finished

**Dial Face** Aluminum, white background with black graduations and markings

**Accuracy** ±1.0% Full Scale, ASME B40.100 Grade 1A

**Maximum Temperature** 250°F (121°C)

#### Approximate Shipping Weight

3 1/2" Dial Size:  
0.7 lbs [0.32 kg]

4 1/2" Dial Size:  
1.1 lbs [0.50 kg]

### HOW TO ORDER

Sample Order Number: **600CB 35 02 L A 090**

Model	Dial Size	Connection Size	Connection Location	Units of Measure	Range Code
600CB	35 3 1/2" 45 4 1/2"	02 1/4 NPT	L Lower	A psi B kPa C kg/cm <sup>2</sup> D psi/kPa E psi & kg/cm <sup>2</sup>	See Standard Ranges

# 700 Series

All dimensions are nominal. Dimensions in [ ] are in millimeters.

## Field Liquid Fillable • Stainless Steel Case

INDUSTRIAL GAUGES

Dial Size	Material	C	E	F	G	H	J
4"	Brass	3.98 [101]	3.39 [86]	0.94 [24]	1.04 [27]	1.44 [37]	2.24 [57]
	SS	3.98 [101]	3.39 [86]	0.94 [24]	1.36 [35]	1.38 [35]	2.24 [57]
6"	Brass	6.34 [161]	4.57 [116]	0.69 [18]	1.04 [27]	1.44 [37]	1.97 [50]
	SS	6.34 [161]	4.57 [116]	0.69 [18]	1.36 [35]	1.38 [35]	1.97 [50]

2 1/2"

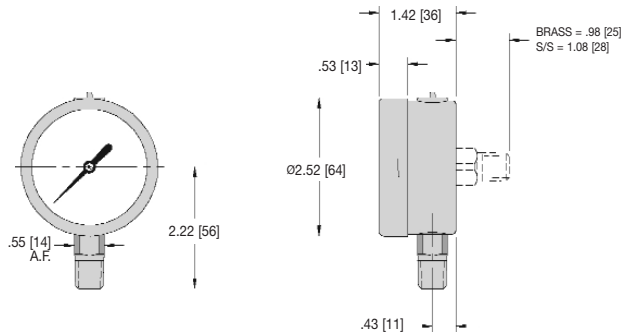

4" & 6"

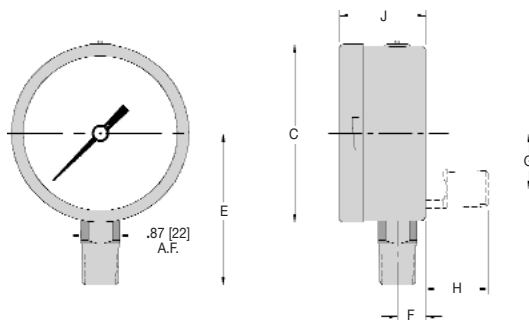

### Standard Ranges

psi Ranges (A)			
All Sizes			
Range Code	Specific Range (psi)	Figure Intervals	Minor Divisions
010	30" Hg to 0	5	0.5
020	30" Hg to 15 psi	10/5	0.5/0.5
030	30" Hg to 30 psi	10/5	1/1
040	30" Hg to 60 psi	10/10	2/1
050	30" Hg to 100 psi	30/20	2/2
060	30" Hg to 150 psi	30/20	5/2
070	30" Hg to 300 psi	30/50	5/5
080	0 to 15 psi	3	0.2
090	0 to 30 psi	5	0.5
100	0 to 60 psi	10	1
110	0 to 100 psi	10	1
120	0 to 160 psi	20	2
130	0 to 200 psi	20	2
140	0 to 300 psi	50	5
150	0 to 400 psi	50	5
160	0 to 600 psi	100	10
Ranges over 600 psi are not available in 700B or 700LFB in 4" or 6" Dial Sizes.			
180	0 to 1000 psi	100	20
190	0 to 1500 psi	300	20
200	0 to 2000 psi	200	20
210	0 to 3000 psi	500	50
220	0 to 5000 psi	1000	100
230	0 to 10,000 psi	2000	200
Ranges over 10,000 psi are ONLY available in 700SS or 700LFSS in 4" or 6" Dial Sizes.			
240	0 to 15,000 psi	2000	200
250	0 to 20,000 psi	2000	200

For dual scale ranges, specify the appropriate **Units of Measure: D (psi/kPa)** followed by the corresponding **A (psi) Range Code**. Other pressure ranges are also available including: Altitude, Ammonia, Refrigerant and Receiver. Consult Special Application Ranges section or factory for availability.

# 600CB

## Cast Aluminum Case

COMMERCIAL • CONTRACTOR GAUGES



600CB shown



- ▶ 3 1/2" & 4 1/2" Dial Sizes
- ▶ ±1.0% Accuracy
- ▶ Cast Aluminum Case
- ▶ Adjustable Pointer

The **600CB** Terrice Contractor Gauge is among the most frequently specified HVACR gauges within the construction industry. This gauge offers high reliability at a moderate price. The 600CB is furnished with a cast aluminum case and an adjustable pointer.

- Optional features and case style variations available: Please consult the Options & Accessories Section for details.
- For correct use and application of all pressure gauges, please refer to: Pressure Gauge Standard ASME B40.100.

### Specifications

#### Model

**600CB**

**Dial Sizes** 3 1/2", 4 1/2"

#### Wetted Parts

3 1/2" Dial Size:  
Bronze tube, brass socket  
4 1/2" Dial Size:  
Brass tube & socket

**Movement** Brass

**Connection** Lower male, 1/4 NPT

**Case** Cast aluminum, black finished, stem-mounted flangeless

**Ring** 3 1/2" Dial Size: Friction type, steel, black finished  
4 1/2" Dial Size: Friction type, 304 stainless steel

**Window** Clear glass

**Pointer** Adjustable, black finished

**Dial Face** Aluminum, white background with black graduations and markings

**Accuracy** ±1.0% Full Scale, ASME B40.100 Grade 1A

**Maximum Temperature** 250°F (121°C)

#### Approximate Shipping Weight

3 1/2" Dial Size:  
0.7 lbs [0.32 kg]  
4 1/2" Dial Size:  
1.1 lbs [0.50 kg]

### HOW TO ORDER

Sample Order Number: **600CB 35 02 L A 090**

Model	Dial Size	Connection Size	Connection Location	Units of Measure	Range Code
<b>600CB</b>	<b>35</b> 3 1/2" <b>45</b> 4 1/2"	<b>02</b> 1/4 NPT	<b>L</b> Lower	<b>A</b> psi <b>B</b> kPa <b>C</b> kg/cm <sup>2</sup> <b>D</b> psi/kPa <b>E</b> psi & kg/cm <sup>2</sup>	See Standard Ranges

# 600CB

## Cast Aluminum Case

All dimensions are nominal. Dimensions in [ ] are in millimeters.

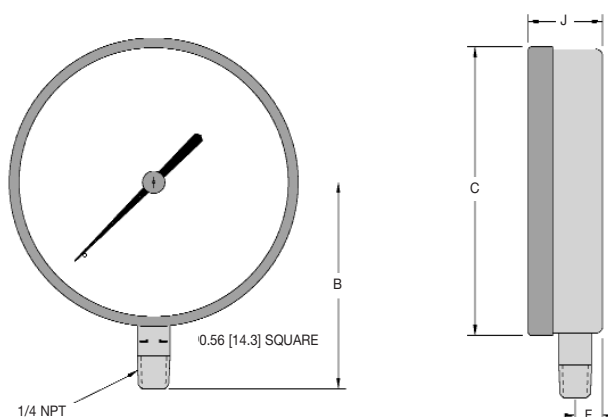

Dial Size	B	C	F	J
3 1/2"	3.06 [77.8]	3.88 [98.6]	0.44 [11.2]	1.22 [31]
4 1/2"	3.54 [89.9]	4.96 [126]	0.47 [11.9]	1.28 [32.5]

### Standard Ranges

psi Ranges (A)				kPa Ranges (B)				kg/cm <sup>2</sup> Ranges (C)			
Range Code	Specific Range (psi)	Figure Intervals	Minor Divisions	Range Code	Specific Range	Figure Intervals	Minor Divisions	Range Code	Specific Range	Figure Intervals	Minor Divisions
010	30" Hg to 0	5	0.2	010	-100 to 0 kPa	10	1	010	76 cm Hg to 0	10	0.5
020	30" Hg to 15 psi	5/5	0.5/0.2	020	-100 to 100 kPa	20	2	020	76 cm Hg to 1 kg/cm <sup>2</sup>	20/0.2	1/0.2
030	30" Hg to 30 psi	10/5	1/0.5	030	-100 to 200 kPa	50	2	030	76 cm Hg to 2 kg/cm <sup>2</sup>	20/0.5	2/0.2
040	30" Hg to 60 psi	10/10	1/1	040	-100 to 400 kPa	50	5	040	76 cm Hg to 4 kg/cm <sup>2</sup>	25/0.5	5/0.5
050	30" Hg to 100 psi	30/10	2/1	050	-100 to 700 kPa	100	5	050	76 cm Hg to 7 kg/cm <sup>2</sup>	76/1	5/0.1
060	30" Hg to 150 psi	30/20	5/2	060	-100 to 1000 kPa	100	10	060	76 cm Hg to 10 kg/cm <sup>2</sup>	76/1	15/0.1
070	30" Hg to 300 psi	30/50	5/2	070	-100 to 2000 kPa	200	20	070	76 cm Hg to 21 kg/cm <sup>2</sup>	76/2	19/0.2
080	0 to 15 psi	3	0.1	080	0 to 100 kPa	10	1	080	0 to 1 kg/cm <sup>2</sup>	0.1	0.01
090	0 to 30 psi	5	0.2	090	0 to 200 kPa	20	2	090	0 to 2 kg/cm <sup>2</sup>	0.2	0.02
100	0 to 60 psi	10	0.5	100	0 to 400 kPa	50	5	100	0 to 4.2 kg/cm <sup>2</sup>	0.5	0.5
110	0 to 100 psi	10	1	110	0 to 700 kPa	100	5	110	0 to 7 kg/cm <sup>2</sup>	1	0.5
120	0 to 160 psi	20	1	120	0 to 1200 kPa	200	10	120	0 to 11 kg/cm <sup>2</sup>	1	0.1
130	0 to 200 psi	20	2	130	0 to 1500 kPa	300	10	130	0 to 14 kg/cm <sup>2</sup>	2	0.1
140	0 to 300 psi	50	2	140	0 to 2000 kPa	200	20	140	0 to 21 kg/cm <sup>2</sup>	3	0.2
150	0 to 400 psi	50	5	150	0 to 3000 kPa	300	20	150	0 to 28 kg/cm <sup>2</sup>	4	0.2
160	0 to 600 psi	50	5	160	0 to 4000 kPa	500	50	160	0 to 42 kg/cm <sup>2</sup>	6	0.5
180	0 to 1000 psi	100	10	180	0 to 7000 kPa	1000	50	180	0 to 70 kg/cm <sup>2</sup>	10	0.5

For dual scale ranges, specify the appropriate **Units of Measure: D (psi/kPa) or E (psi & kg/cm<sup>2</sup>)** followed by the equivalent **A (psi) Range Code**. Other pressure ranges are also available including: Altitude, Ammonia, Refrigerant and Receiver. Consult Special Application Ranges section or factory for availability.

COMMERCIAL • CONTRACTOR GAUGES

# 610CB

## Glass Filled Nylon Case

COMMERCIAL • CONTRACTOR GAUGES



610CB shown



- ▶ 4 1/2" Dial Size
- ▶ ±1.0% Accuracy
- ▶ Back Flanged, Glass Filled Nylon Case
- ▶ Adjustable Pointer

The **610CB Trerice Contractor Gauge** is designed to service the pressure measurement requirements of the construction and transportation industries. The 610CB is furnished with a corrosion resistant plastic case and an adjustable pointer. Wetted parts are a bronze tube with brass socket.

- Optional features available: Please consult the Options & Accessories Section for details.
- For correct use and application of all pressure gauges, please refer to: Pressure Gauge Standard ASME B40.100.

### Specifications

<b>Model</b>	<b>610CB</b>
<b>Dial Size</b>	4 1/2"
<b>Wetted Parts</b>	Bronze tube, brass socket
<b>Movement</b>	Brass
<b>Connection</b>	Lower male, 1/4 NPT
<b>Case</b>	Glass filled nylon, surface mounted back flanged
<b>Ring</b>	Friction type, 304 stainless steel
<b>Window</b>	Clear glass
<b>Pointer</b>	Adjustable, black finished
<b>Dial Face</b>	Aluminum, white background with black graduations and markings
<b>Accuracy</b>	±1.0% Full Scale, ASME B40.100 Grade 1A
<b>Maximum Temperature</b>	<b>250°F (121°C)</b>
<b>Approximate Shipping Weight</b>	0.9 lbs [0.41 kg]

### HOW TO ORDER

Sample Order Number: **610CB 45 02 L A 110**

Model	Dial Size	Connection Size	Connection Location	Units of Measure	Range Code
610CB	45 4 1/2"	02 1/4 NPT	L Lower	A psi B kPa C kg/cm <sup>2</sup> D psi/kPa E psi & kg/cm <sup>2</sup>	See Standard Ranges



# 610CB

## Glass Filled Nylon Case

All dimensions are nominal. Dimensions in [ ] are in millimeters.

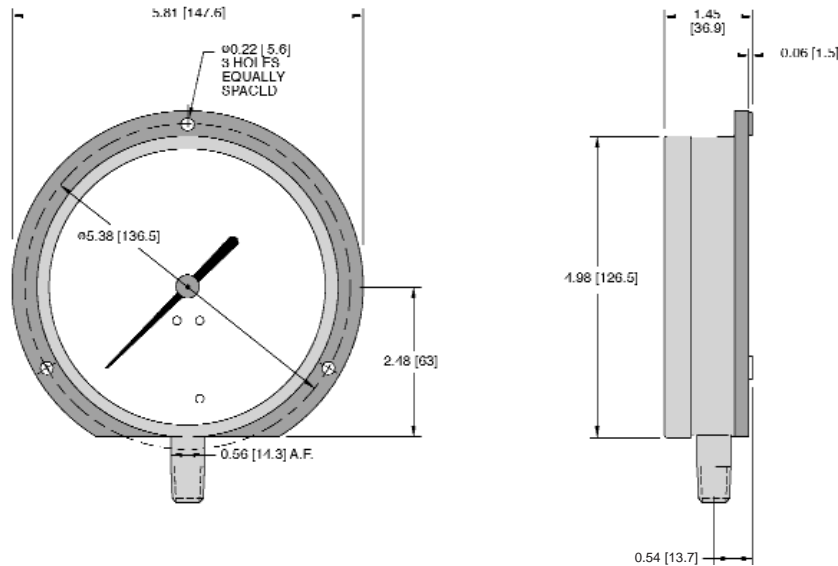

COMMERCIAL • CONTRACTOR GAUGES

### Standard Ranges

psi Ranges (A)				kPa Ranges (B)				kg/cm <sup>2</sup> Ranges (C)			
Range Code	Specific Range (psi)	Figure Intervals	Minor Divisions	Range Code	Specific Range	Figure Intervals	Minor Divisions	Range Code	Specific Range	Figure Intervals	Minor Divisions
010	30" Hg to 0	5	0.2	010	-100 to 0 kPa	10	1	010	76 cm Hg to 0	10	0.5
020	30" Hg to 15 psi	5/5	0.5/0.2	020	-100 to 100 kPa	20	2	020	76 cm Hg to 1 kg/cm <sup>2</sup>	20/0.2	1/0.2
030	30" Hg to 30 psi	10/5	1/0.5	030	-100 to 200 kPa	50	2	030	76 cm Hg to 2 kg/cm <sup>2</sup>	20/0.5	2/0.2
040	30" Hg to 60 psi	10/10	1/1	040	-100 to 400 kPa	50	5	040	76 cm Hg to 4 kg/cm <sup>2</sup>	25/0.5	5/0.5
050	30" Hg to 100 psi	30/10	2/1	050	-100 to 700 kPa	100	5	050	76 cm Hg to 7 kg/cm <sup>2</sup>	76/1	5/0.1
060	30" Hg to 150 psi	30/20	5/2	060	-100 to 1000 kPa	100	10	060	76 cm Hg to 10 kg/cm <sup>2</sup>	76/1	15/0.1
070	30" Hg to 300 psi	30/50	5/2	070	-100 to 2000 kPa	200	20	070	76 cm Hg to 21 kg/cm <sup>2</sup>	76/2	19/0.2
080	0 to 15 psi	3	0.1	080	0 to 100 kPa	10	1	080	0 to 1 kg/cm <sup>2</sup>	0.1	0.01
090	0 to 30 psi	5	0.2	090	0 to 200 kPa	20	2	090	0 to 2 kg/cm <sup>2</sup>	0.2	0.02
100	0 to 60 psi	10	0.5	100	0 to 400 kPa	50	5	100	0 to 4.2 kg/cm <sup>2</sup>	0.5	0.5
110	0 to 100 psi	10	1	110	0 to 700 kPa	100	5	110	0 to 7 kg/cm <sup>2</sup>	1	0.5
120	0 to 160 psi	20	1	120	0 to 1200 kPa	200	10	120	0 to 11 kg/cm <sup>2</sup>	1	0.1
130	0 to 200 psi	20	2	130	0 to 1500 kPa	300	10	130	0 to 14 kg/cm <sup>2</sup>	2	0.1
140	0 to 300 psi	50	2	140	0 to 2000 kPa	200	20	140	0 to 21 kg/cm <sup>2</sup>	3	0.2
150	0 to 400 psi	50	5	150	0 to 3000 kPa	300	20	150	0 to 28 kg/cm <sup>2</sup>	4	0.2
160	0 to 600 psi	50	5	160	0 to 4000 kPa	500	50	160	0 to 42 kg/cm <sup>2</sup>	6	0.5
180	0 to 1000 psi	100	10	180	0 to 7000 kPa	1000	50	180	0 to 70 kg/cm <sup>2</sup>	10	0.5

For dual scale ranges, specify the appropriate **Units of Measure: D (psi/kPa) or E (psi & kg/cm<sup>2</sup>)** followed by the equivalent **A (psi) Range Code**. Other pressure ranges are also available including: Altitude, Ammonia, Refrigerant and Receiver. Consult Special Application Ranges section or factory for availability.

# 690 Series

## Multiple Stainless Steel Case Styles

COMMERCIAL • CONTRACTOR GAUGES



690B shown



- ▶ 3 1/2" Dial Size
- ▶ ±1.0% Accuracy
- ▶ Polished Stainless Steel Case
- ▶ Multiple Case Styles

Terrice **690 Series** Commercial Gauges are offered in a polished stainless steel case to provide the durability and styling required in OEM and other applications. This gauge is available in a variety of case styles. Wetted parts are a bronze tube with brass socket.

- Optional features available: Please consult the Options & Accessories Section for details.
- For correct use and application of all pressure gauges, please refer to: Pressure Gauge Standard ASME B40.100.

### HOW TO ORDER







Sample Order Number: **690B 35 02 L D 110**

Model	Dial Size	Connection Size	Connection Location	Units of Measure	Range Code
690B 691B 692B 693B 694B 696B	35 3 1/2"	02 1/4 NPT	L Lower * B Back **	D psi/kPa A psi B kPa	See Standard Ranges

\* For Models 690B & 692B only

\*\* For Models 691B, 693B, 694B & 696B only

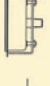
### Specifications

Models	Case Styles
690B	 <b>Flangeless,</b> stem mounted with bottom outlet
691B	 <b>Flangeless,</b> stem mounted with back outlet
692B	 <b>Surface Mounted,</b> back flanged with bottom outlet
693B	 <b>Flush Mounted,</b> front flanged with back outlet
694B	 <b>Flush Mounted,</b> u-clamp with back outlet
696B	 <b>Surface Mounted,</b> back flanged with back outlet

**Dial Size** 3 1/2"

#### Wetted Parts

Bronze tube, brass socket

**Movement** Brass

#### Connection 690B, 692B:

Lower male, 1/4 NPT

#### 691B, 693B, 694B, 696B:

Center back male, 1/4 NPT

**Window** Acrylic, snap-in

**Pointer** Adjustable, black finish

**Dial Face** Aluminum, white background with black graduations and markings

**Accuracy** ±1.0% Full Scale, ASME B40.100 Grade 1A

**Maximum Temperature** 150°F (65°C)

#### Approximate Shipping Weight

690B, 691B, 692B, 696B:  
0.6 lbs [0.27 kg]

693B:  
0.8 lbs [0.36 kg]

694B:  
0.9 lbs [0.41 kg]

# 620B

## Stainless Steel Case

All dimensions are nominal. Dimensions in [ ] are in millimeters.

COMMERCIAL • CONTRACTOR GAUGES

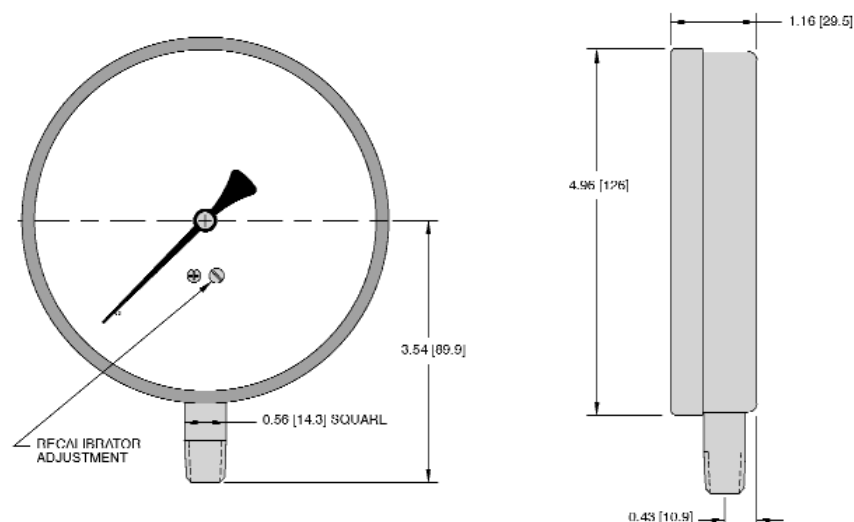

### Standard Ranges

psi Ranges (A)				psi/kPa Ranges (D)					
Range Code	Specific Range (psi)	Figure Intervals	Minor Divisions	Range Code	Specific Range	psi		kPa	
						Figure Intervals	Minor Divisions	Figure Intervals	Minor Divisions
010	30" Hg to 0	5	0.2	010	30" Hg to 0 / -100 to 0 kPa	5	0.2	10	1
020	30" Hg to 15 psi	5/5	0.5/0.2	020	30" Hg to 15 psi / -100 to 100 kPa	5/5	0.5/0.2	20	2
030	30" Hg to 30 psi	10/5	1/0.5	030	30" Hg to 30 psi / -100 to 200 kPa	10/5	1/0.5	50	5
040	30" Hg to 60 psi	10/10	1/1	040	30" Hg to 60 psi / -100 to 400 kPa	10/10	1/1	50	5
050	30" Hg to 100 psi	30/10	2/1	050	30" Hg to 100 psi / -100 to 700 kPa	30/10	2/1	100	5
060	30" Hg to 150 psi	30/20	5/2	060	30" Hg to 150 psi / -100 to 1000 kPa	30/20	5/2	100	10
070	30" Hg to 300 psi	30/50	5/2	070	30" Hg to 300 psi / -100 to 2000 kPa	30/50	5/2	200	20
080	0 to 15 psi	3	0.1	080	0 to 15 psi / 0 to 100 kPa	3	0.1	10	1
090	0 to 30 psi	5	0.2	090	0 to 30 psi / 0 to 200 kPa	5	0.2	20	2
100	0 to 60 psi	10	0.5	100	0 to 60 psi / 0 to 400 kPa	10	0.5	50	5
110	0 to 100 psi	10	1	110	0 to 100 psi / 0 to 700 kPa	10	1	100	5
120	0 to 160 psi	20	1	120	0 to 160 psi / 0 to 1100 kPa	20	1	200	10
130	0 to 200 psi	20	2	130	0 to 200 psi / 0 to 1400 kPa	20	2	300	10
140	0 to 300 psi	50	2	140	0 to 300 psi / 0 to 2000 kPa	50	2	200	20
150	0 to 400 psi	50	5	150	0 to 400 psi / 0 to 2800 kPa	50	5	300	50
160	0 to 600 psi	50	5	160	0 to 600 psi / 0 to 4000 kPa	50	5	500	50

# 690 Series

## Multiple Stainless Steel Case Styles

COMMERCIAL • CONTRACTOR GAUGES



690B shown



- ▶ 3 1/2" Dial Size
- ▶ ±1.0% Accuracy
- ▶ Polished Stainless Steel Case
- ▶ Multiple Case Styles

Trerice **690 Series** Commercial Gauges are offered in a polished stainless steel case to provide the durability and styling required in OEM and other applications. This gauge is available in a variety of case styles. Wetted parts are a bronze tube with brass socket.

- Optional features available: Please consult the Options & Accessories Section for details.
- For correct use and application of all pressure gauges, please refer to: Pressure Gauge Standard ASME B40.100.

### HOW TO ORDER





Sample Order Number: **690B 35 02 L D 110**

Model	Dial Size	Connection Size	Connection Location	Units of Measure	Range Code
690B 691B 692B 693B 694B 696B	35 3 1/2"	02 1/4 NPT	L Lower * B Back **	D psi/kPa A psi B kPa	See Standard Ranges

\* For Models 690B & 692B only

\*\* For Models 691B, 693B, 694B & 696B only

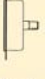
### Specifications

Models	Case Styles
690B	 <b>Flangeless</b> , stem mounted with bottom outlet
691B	 <b>Flangeless</b> , stem mounted with back outlet
692B	 <b>Surface Mounted</b> , back flanged with bottom outlet
693B	 <b>Flush Mounted</b> , front flanged with bottom outlet
694B	 <b>Flush Mounted</b> , u-clamp with back outlet
696B	 <b>Surface Mounted</b> , back flanged with back outlet

**Dial Size** 3 1/2"

#### Wetted Parts

Bronze tube, brass socket

**Movement** Brass

#### Connection 690B, 692B:

Lower male, 1/4 NPT

**691B, 693B, 694B, 696B:**  
Center back male, 1/4 NPT

**Window** Acrylic, snap-in

**Pointer** Adjustable, black finish

**Dial Face** Aluminum, white background with black graduations and markings

**Accuracy** ±1.0% Full Scale,  
ASME B40.100 Grade 1A

**Maximum Temperature**  
150°F (65°C)

#### Approximate Shipping Weight

690B, 691B, 692B, 696B:  
0.6 lbs [0.27 kg]

693B:  
0.8 lbs [0.36 kg]

694B:  
0.9 lbs [0.41 kg]

# 690 Series

All dimensions are nominal. Dimensions in [ ] are in millimeters.

## Multiple Stainless Steel Case Styles

COMMERCIAL • CONTRACTOR GAUGES

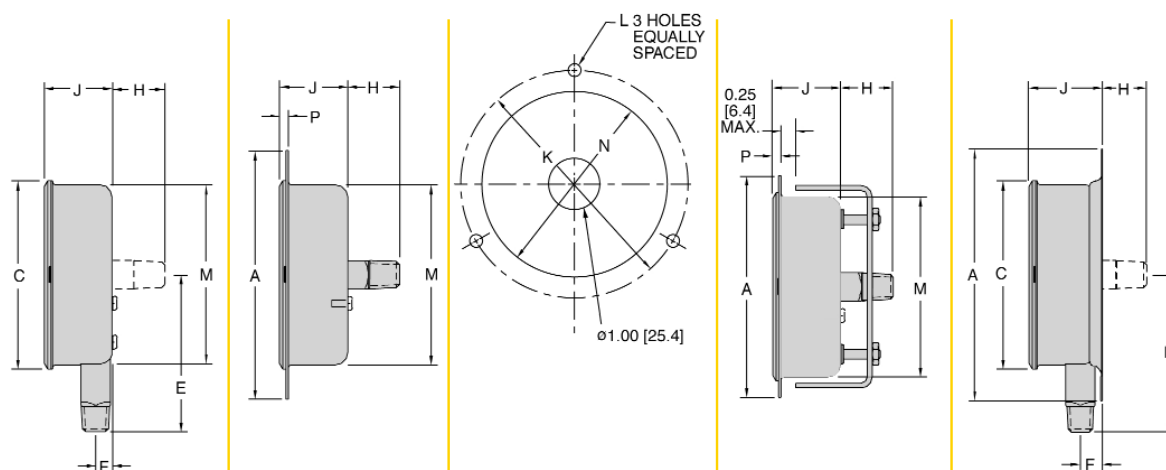

690B / 691B

693B

692B / 693B / 696B

694B

692B / 696B

Model	A	C	E	F	H	J	K	L	M	N	P
690B	N/A	3.67 [93.2]	3.06 [77.8]	0.32 [8.2]	N/A	1.33 [33.8]	N/A	N/A	3.51 [89.2]	N/A	0.17 [4.3]
691B	N/A	3.67 [93.2]	N/A	N/A	1.01 [25.8]	1.33 [33.8]	N/A	N/A	3.51 [89.2]	N/A	0.17 [4.3]
692B	4.91 [124.7]	3.67 [93.2]	3.06 [77.8]	0.43 [11]	0.90 [23.0]	1.44 [36.6]	4.50 [114.3]	0.25 [6.4]	N/A	N/A	N/A
693B	4.84 [122.9]	N/A	N/A	N/A	1.01 [25.8]	1.33 [33.8]	4.44 [112.8]	0.25 [6.4]	3.51 [89.2]	3.62 [92]	0.17 [4.3]
694B	4.31 [109.5]	N/A	N/A	N/A	1.01 [25.8]	1.33 [33.8]	N/A	N/A	3.51 [89.2]	3.62 [92]	0.17 [4.3]
696B	4.91 [124.7]	3.67 [93.2]	N/A	N/A	0.90 [23]	1.44 [36.6]	4.50 [114.3]	0.25 [6.4]	N/A	N/A	N/A

## Standard Ranges

psi/kPa Ranges (D)		psi (A)		kPa (B)	
Range Code	Specific Range (psi)	Figure Intervals	Minor Divisions	Figure Intervals	Minor Divisions
010	30" Hg to 0 / -100 to 0 kPa	5	0.2	10	1
020	30" Hg to 15 psi / -100 to 100 kPa	5/5	0.5/0.2	20	2
030	30" Hg to 30 psi / -100 to 200 kPa	10/5	1/0.5	50	2
040	30" Hg to 60 psi / -100 to 400 kPa	10/10	1/1	50	5
050	30" Hg to 100 psi / -100 to 700 kPa	30/10	2/1	100	5
060	30" Hg to 150 psi / -100 to 1000 kPa	30/20	5/2	100	10
070	30" Hg to 300 psi / -100 to 2000 kPa	30/50	5/2	100	20
080	0 to 15 psi / 0 to 100 kPa	3	0.1	10	1
090	0 to 30 psi / 0 to 200 kPa	5	0.2	20	2
100	0 to 60 psi / 0 to 400 kPa	10	0.5	50	5
110	0 to 100 psi / 0 to 700 kPa	10	1	100	5
120	0 to 160 psi / 0 to 1100 kPa	20	1	100	10
130	0 to 200 psi / 0 to 1400 kPa	20	2	200	10
140	0 to 300 psi / 0 to 2000 kPa	50	2	200	20
150	0 to 400 psi / 0 to 2800 kPa	50	5	400	20
160	0 to 600 psi / 0 to 4000 kPa	50	5	500	50
180	0 to 1000 psi / 0 to 7000 kPa	100	10	1000	50

Other pressure ranges are also available including: Altitude, Refrigerant and Receiver. Consult Special Application Ranges section or factory for availability.

# D80 Series

Dry or Liquid Filled • Stainless Steel Case

UTILITY GAUGES



D82LFB shown



- ▶ 1 1/2", 2", 2 1/2", 4" Dial Sizes
- ▶ ±1.6% Accuracy
- ▶ Stainless Steel Case
- ▶ Glycerine Fill Standard

The Trerice **D80 Series** Utility Gauge is designed for rugged performance requirements at an economical cost. This liquid filled gauge is furnished with a stainless steel case and crimped ring. Wetted parts are either bronze tube with brass socket or stainless steel.

- Optional features and case style variations available: Please consult the Options & Accessories Section for details.
- For correct use and application of all pressure gauges, please refer to: Pressure Gauge Standard ASME B40.100.

## Specifications

Models	Wetted Parts	
D82B	(dry)	Bronze tube,
D82LFB	(liquid filled)	brass socket
D83SS	(dry)	316 Stainless steel
D83LFSS	(liquid filled)	tube & socket
<b>Dial Sizes</b>	1 1/2", 2", 2 1/2", 4"	
<b>Fill</b>	Glycerine, other fills available See Optional Features Section	
<b>Movement</b>	D82: Brass D83: 316 Stainless steel	
<b>Connection</b>	Lower male or center back male, Lower back male on 4" D83	
<b>Case</b>	304 stainless steel, stem-mounted flangeless	
<b>Ring</b>	Crimped 304 stainless steel	
<b>Window</b>	Acrylic	
<b>Pointer</b>	Plain, black finished	
<b>Dial Face</b>	Aluminum, white background with black graduations and markings	
<b>Additional Features</b>	Restrictor screw standard on D83LFSS and D83SS	
<b>Accuracy</b>	±1.6% Full Scale	
<b>Maximum Temperature</b>	150°F (65°C)	
<b>Approximate Shipping Weight</b>	1 1/2" Dial Size: 0.4 lbs [0.18 kg]  2" Dial Size: 0.4 lbs [0.18 kg]  2 1/2" Dial Size: 0.5 lbs [0.23 kg]  4" Dial Size: 1.0 lbs [0.45 kg]	

## HOW TO ORDER

Sample Order Number: **D82LFB 25 02 L A 110**

Model	Dial Size	Connection Size	Connection Location	Units of Measure	Range Code
D82LFB	15 1 1/2"	01 1/8 NPT*	L Lower	A psi	See Standard Ranges
D83LFSS	20 2"	02 1/4 NPT**	B Back	D psi/kPa	
D82B	25 2 1/2"				
D83SS	40 4"				

\* 1/8 NPT connection size not available with 4" dial size.

\*\* 1/4 NPT connection size not available with 1 1/2" dial size.

# D80 Series

All dimensions are nominal. Dimensions in [ ] are in millimeters.

Dry or Liquid Filled • Stainless Steel Case

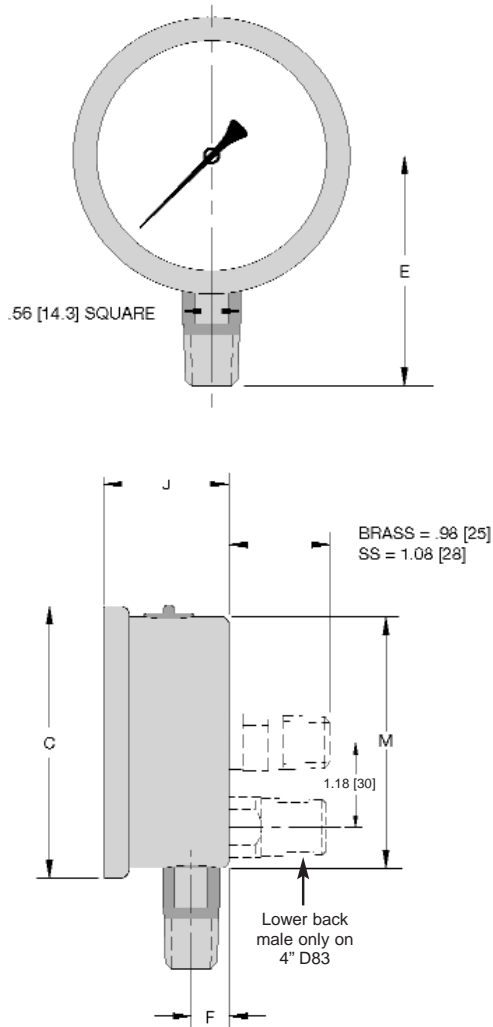

## Standard Ranges

psi Ranges (A)		D82		D83	
Range Code	Specific Range (psi)	Figure Intervals	Minor Divisions	Figure Intervals	Minor Divisions
010	30" Hg to 0	5	0.5	5	0.5
020	30" Hg to 15 psi	10/5	1/0.5	10/5	1/0.5
030	30" Hg to 30 psi	10/10	2/1	10/5	2/1
040	30" Hg to 60 psi	10/10	2/2	10/10	2/1
050	30" Hg to 100 psi	30/20	2/2	30/20	5/2
060	30" Hg to 150 psi	30/30	10/5	30/30	10/5
070	30" Hg to 300 psi	30/50	10/5	30/50	10/5
080	0 to 15 psi	3	0.2	3	0.2
090	0 to 30 psi	5	0.5	5	0.5
100	0 to 60 psi	10	1	10	1
110	0 to 100 psi	20	2	10	2
120	0 to 160 psi	20	2	20	2
130	0 to 200 psi	20	2	20	2
140	0 to 300 psi	50	5	50	5
150	0 to 400 psi	50	5	50	5
160	0 to 600 psi	100	10	100	10
180	0 to 1000 psi	100	25	100	20
190	0 to 1500 psi	300	20	300	25
200	0 to 2000 psi	200	20	200	25
210	0 to 3000 psi	500	50	500	50
220	0 to 5000 psi	1000	100	1000	100

230	0 to 10000 psi	N/A	N/A	N/A	N/A
240	0 to 15000 psi	N/A	N/A	N/A	N/A

For dual scale ranges specify the appropriate Units of Measure: **D** (psi/kPa) followed by the corresponding **A** (psi) **Range Code**

Dial Size	C	E	F	J	M
1 1/2" D82	1.85 [47]	1.50 [38]	0.32 [8]	1.06 [27]	1.61 [41]
1 1/2" D83	1.85 [47]	1.50 [38]	0.32 [8]	1.06 [27]	1.61 [41]
2" D82	2.28 [58]	1.89 [48]	0.39 [10]	1.14 [29]	2.05 [52]
2" D83	2.28 [58]	2.05 [52]	0.35 [9]	1.18 [30]	2.05 [52]
2 1/2" D82	2.68 [68]	2.24 [57]	0.39 [10]	1.18 [30]	2.44 [62]
2 1/2" D83	2.68 [68]	2.32 [59]	0.51 [13]	1.38 [35]	2.44 [62]
4" D82	4.29 [109]	3.07 [78]	0.47 [12]	1.42 [36]	3.90 [99]
4" D83	4.29 [109]	3.94 [100]	0.75 [19]	1.93 [49]	3.94 [100]

UTILITY GAUGES



# 800B

Dry • Black Finished Steel Case

UTILITY GAUGES



800B shown

- ▶ 1 1/2", 2", 2 1/2", 4" Dial Sizes
- ▶ ±1.6% Accuracy
- ▶ Drawn Steel Case

The Trerice **800B** Utility Gauge is designed for general pressure indication requirements. This gauge provides reliable service at an economical cost. Wetted parts are bronze tube and brass socket.

- Optional features and case style variations available: Please consult the Options & Accessories Section for details.
- For correct use and application of all pressure gauges, please refer to: Pressure Gauge Standard ASME B40.100.

## Specifications

### Model

**800B**

**Dial Sizes** 1 1/2", 2", 2 1/2", 4"

### Wetted Parts

Bronze tube, brass socket

**Movement** Brass

**Connection** 1 1/2" Dial Size: Lower male or center back male, 1/8 NPT  
2", 2 1/2" Dial Size: Lower male or center back male, 1/8 or 1/4 NPT  
4" Dial Size: Lower male or center back male, 1/4 NPT

**Case** Drawn steel, black finished, stem-mounted flangeless

**Window** Acrylic

**Pointer** Plain, black finished

**Dial Face** Aluminum, white background with black graduations and markings

**Accuracy** ±1.6% Full Scale

**Maximum Temperature**  
**180°F (82°C)**

### Approximate Shipping Weight

1 1/2" Dial Size:  
0.2 lbs [0.09 kg]  
2" Dial Size:  
0.3 lbs [0.14 kg]  
2 1/2" Dial Size:  
0.3 lbs [0.14 kg]  
4" Dial Size:  
0.6 lbs [0.27 kg]

## HOW TO ORDER

Sample Order Number: **800B 15 01 B D 110**

Model	Dial Size	Connection Size	Connection Location	Units of Measure	Range Code
800B	15 1 1/2"	01 1/8 NPT	L Lower	A psi	See Standard Ranges
	20 2"	02 1/4 NPT	B Back	D psi/kPa	
	25 2 1/2"				
	40 4"				

\* 1 1/2" dial size available only with 1/8 NPT connection.

All dimensions are nominal. Dimensions in [ ] are in millimeters.

**Dry • Black Finished Steel Case**

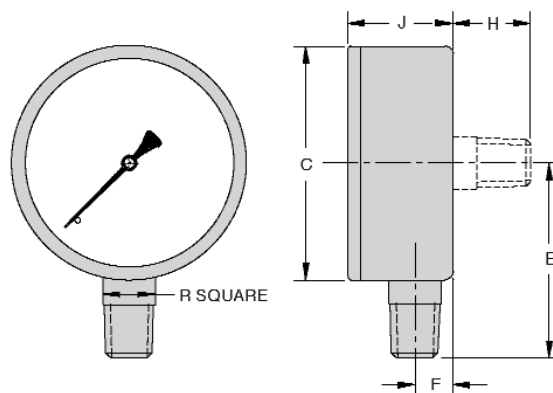

UTILITY GAUGES

Dial Size	C	E	F	H	J	R
1 1/2" Lower	1.57 [40]	1.54 [39]	0.35 [9]	0.71 [18]	1.02 [26]	0.43 [11]
1 1/2" Back	1.57 [40]	1.54 [39]	0.35 [9]	0.71 [18]	1.14 [29]	0.43 [11]
2"	1.97 [50]	1.93 [49]	0.39 [10]	0.83 [21]	1.14 [29]	0.55 [14]
2 1/2"	2.48 [63]	2.20 [56]	0.39 [10]	0.83 [21]	1.14 [29]	0.55 [14]
4"	3.94 [100]	2.87 [73]	0.39 [10]	N/A	1.14 [29]	0.55 [14]

## Standard Ranges

psi Ranges (A)				psi/kPa Ranges (D)					
Range Code	Specific Range	Figure Intervals	Minor Divisions	Range Code	Specific Range	Figure Intervals	Minor Divisions	Figure Intervals	Minor Divisions
010	30" Hg to 0	5	0.5	010	30" Hg to 0 / -100 to 0 kPa	5	0.5	10	2
020	30" Hg to 15 psi	10/5	1/0.5	020	30" Hg to 15 psi / -100 to 100 kPa	10/3	2/0.5	10	5
030	30" Hg to 30 psi	10/5	2/1	030	30" Hg to 30 psi / -100 to 200 kPa	10/5	2/1	50	10
040	30" Hg to 60 psi	10/10	5/2	040	30" Hg to 60 psi / -100 to 400 kPa	10/10	5/2	5	20
050	30" Hg to 100 psi	30/20	5/2	050	30" Hg to 100 psi / -100 to 700 kPa	30/20	5/2	5	20
060	30" Hg to 150 psi	30/30	5/5	060	30" Hg to 150 psi / -100 to 1000 kPa	30/30	5/5	5	50
070	30" Hg to 300 psi	30/30	10/10	070	30" Hg to 300 psi / -100 to 2000 kPa	30/50	5/10	10	50
080	0 to 15 psi	3	0.5	080	0 to 15 psi / 0 to 100 kPa	3	0.5	10	2
090	0 to 30 psi	5	0.5	090	0 to 30 psi / 0 to 200 kPa	5	0.5	20	2
100	0 to 60 psi	10	1	100	0 to 60 psi / 0 to 400 kPa	10	1	50	5
110	0 to 100 psi	10	2	110	0 to 100 psi / 0 to 700 kPa	10	2	100	20
120	0 to 160 psi	20	2	120	0 to 160 psi / 0 to 1100 kPa	20	2	100	20
130	0 to 200 psi	20	2	130	0 to 200 psi / 0 to 1400 kPa	20	2	200	20
140	0 to 300 psi	50	5	140	0 to 300 psi / 0 to 2000 kPa	50	5	200	20
150	0 to 400 psi	50	5	150	0 to 400 psi / 0 to 2800 kPa	50	10	400	40
160	0 to 600 psi	100	10	160	0 to 600 psi / 0 to 4000 kPa	100	20	1000	100
180	0 to 1000 psi	100	20	180	0 to 1000 psi / 0 to 7000 kPa	100	20	1000	200
190	0 to 1500 psi	300	20	190	0 to 1500 psi / 0 to 10,000 kPa	300	20	2000	200
200	0 to 2000 psi	200	20	200	0 to 2000 psi / 0 to 14,000 kPa	200	50	2000	500
210	0 to 3000 psi	500	50	210	0 to 3000 psi / 0 to 20,000 kPa	500	100	5000	500
220	0 to 5000 psi	1000	100	220	0 to 5000 psi / 0 to 35,000 kPa	1000	100	5000	1000

# 800LFB

Liquid Filled • Plastic Case

UTILITY GAUGES



800LFB shown



- ▶ 2", 2 1/2", 3 1/2" Dial Sizes
- ▶ ±1.6% Accuracy (2", 2 1/2")
- ▶ ±1.0% Accuracy (3 1/2")
- ▶ Liquid Filled

The Trerice **800LFB** Utility Gauge is designed to meet the needs of general industrial applications. The gauge features a rugged, plastic, liquid filled case to withstand minor vibration and pulsation conditions. Wetted parts are bronze tube with brass socket.

- Optional features and case style variations available: Please consult the Options & Accessories Section for details.
- For correct use and application of all pressure gauges, please refer to: Pressure Gauge Standard ASME B40.100.

## Specifications

<b>Model</b>	<b>800LFB</b> (liquid filled)
<b>Dial Sizes</b>	2", 2 1/2", 3 1/2"
<b>Wetted Parts</b>	Bronze tube, brass socket
<b>Fill</b>	Glycerine, other fills available See Optional Features Section
<b>Movement</b>	Brass
<b>Connection</b>	Lower male or center back male 1/8 or 1/4 NPT
<b>Case</b>	2", 2 1/2" Dial Size: ABS plastic, stem-mounted flangeless  3 1/2" Dial Size: Nylon, stem-mounted flangeless
<b>Ring</b>	Crimped aluminum, black finished
<b>Window</b>	Styrene-acrylonitrile
<b>Pointer</b>	Plain, black finish
<b>Dial Face</b>	Aluminum, white background with black graduations and markings
<b>Accuracy</b>	2", 2 1/2" Dial Size: ±1.6% Full Scale  3 1/2" Dial Size: ±1.0% Full Scale, ASME B40.100 Grade 1A
<b>Maximum Temperature</b>	<b>150°F (65°C)</b>
<b>Approximate Shipping Weight</b>	2" Dial Size: 0.4 lbs [0.18 kg]  2 1/2" Dial Size: 0.5 lbs [0.23 kg]  3 1/2" Dial Size: 1.0 lbs [0.45 kg]

## HOW TO ORDER

Sample Order Number: **800LFB 25 02 L A 110**

Model	Dial Size	Connection Size	Connection Location	Units of Measure	Range Code
800LFB	20 2"	01 1/8 NPT*	L Lower	A psi	See Standard Ranges
	25 2 1/2"	02 1/4 NPT	B Back	D psi/kPa	
	35 3 1/2"				

\* 1/8 NPT connection size not available with 3 1/2" dial size.

# 800LFB

Liquid Filled • Plastic Case

All dimensions are nominal. Dimensions in [ ] are in millimeters.

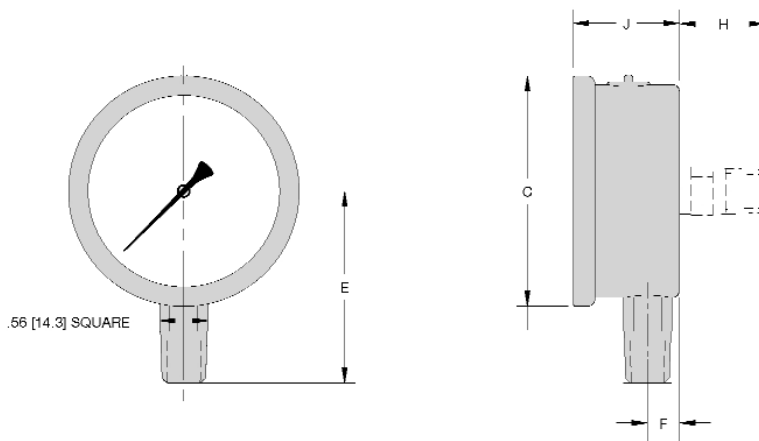

UTILITY GAUGES

Dial Size	C	E	F	H	J
2"	2.09 [53.1]	1.91 [48.5]	0.48 [12.2]	0.98 [24.9]	1.24 [31.2]
2 1/2"	2.67 [67.8]	2.19 [55.5]	0.39 [10.0]	0.99 [25.1]	1.26 [32.5]
3 1/2"	4.23 [107]	2.87 [73.0]	0.48 [12.2]	1.06 [27]	1.41 [36.0]

## Standard Ranges

psi Ranges (A)					
Range Code	Specific Range	2 & 2 1/2" Dial Size		3 1/2" Dial Size	
		Figure Intervals	Minor Divisions	Figure Intervals	Minor Divisions
010	30" Hg to 0	5	1	5	0.5
020	30" Hg to 15 psi	10/3	2/0.5	10/5	0.5/0.5
030	30" Hg to 30 psi	10/5	2/1	10/5	1/1
040	30" Hg to 60 psi	10/10	5/2	10/10	2/1
050	30" Hg to 100 psi	30/10	5/2	30/20	2/2
060	30" Hg to 150 psi	30/30	5/5	30/20	5/2
070	30" Hg to 300 psi	30/30	5/10	30/50	5/5
080	0 to 15 psi	3	0.5	3	0.2
090	0 to 30 psi	5	1	5	0.5
100	0 to 60 psi	10	2	10	1
110	0 to 100 psi	10	2	10	2
120	0 to 160 psi	20	2	20	2
130	0 to 200 psi	20	4	20	2
140	0 to 300 psi	50	10	50	5
150	0 to 400 psi	50	10	50	5
160	0 to 600 psi	100	20	100	10
180	0 to 1000 psi	100	20	100	20
190	0 to 1500 psi	300	50	300	20
200	0 to 2000 psi	200	40	200	20
210	0 to 3000 psi	500	100	500	50
220	0 to 5000 psi	500	100	1000	100

For dual scale ranges specify the appropriate Units of Measure: **D** (psi/kPa) followed by the corresponding **A** (psi) **Range Code**

# 760B

## Low Pressure Gauge • Black Finished Steel Case

SPECIALTY GAUGES



760B shown

- ▶ 2 1/2", 4" Dial Sizes
- ▶ ±1.6% Accuracy
- ▶ Drawn Steel Case

The Trerice **760B** Low Pressure Gauge is designed to accurately measure extreme low pressure conditions. This pressure gauge employs a diaphragm capsule sensing element to measure the low pressure. Case material is drawn steel with brass wetted parts.

- Optional features and case style variations available: Please consult the Options & Accessories Section for details.
- For correct use and application of all pressure gauges, please refer to: Pressure Gauge Standard ASME B40.100.



### Specifications

#### Model

760B

**Dial Sizes** 2 1/2", 4"

#### Wetted Parts

316L stainless steel diaphragm capsule, brass socket

**Movement** Brass

**Connection** 2 1/2" Dial Size: Lower male or center back male, 1/4 NPT  
4" Dial Size: Lower male or center back male, 1/4 or 1/2 NPT

**Case** Drawn steel, black finished, stem-mounted flangeless

**Window** Polycarbonate, snap-in

**Pointer** Plain, black finished

**Dial Face** Aluminum, white background with black graduations and markings

**Accuracy** ±1.6% Full Scale

**Maximum Temperature**  
140°F (65°C)

#### Approximate Shipping Weight

2 1/2" Dial Size:  
0.3 lbs [0.14 kg]

4" Dial Size:  
0.89 lbs [0.36 kg]

### HOW TO ORDER

Sample Order Number: **760B 25 02 L T 660**

Model	Dial Size	Connection Size	Connection Location	Units of Measure	Range Code
760B	25 2 1/2" 40 4"	02 1/4 NPT 04 1/2 NPT*	L Lower B Back	T Pressure W Vacuum	See Standard Ranges

\* 1/2 NPT connection size available only with 4" dial size.

# 760B

All dimensions are nominal. Dimensions in [ ] are in millimeters.

## Low Pressure Gauge • Black Finished Steel Case

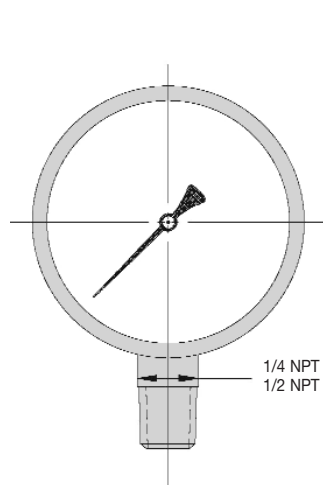

1/4 NPT = .55 [14] A.F.  
1/2 NPT = .87 [22] A.F.

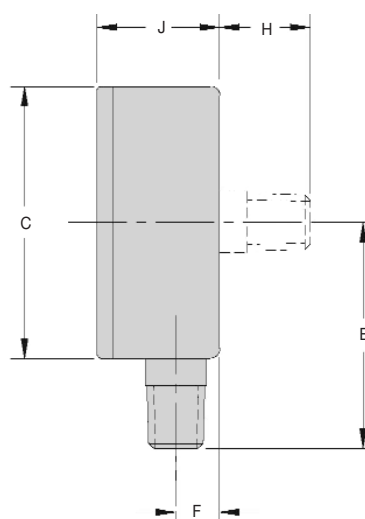

Dial Size	C	E	F	H	J
2 1/2"	2.44 [62]	2.20 [56]	0.37 [9.5]	0.98 [25]	1.34 [34]
4"	3.90 [99]	3.23 [82]	0.61 [16]	0.98 [25]	1.22 [44]
4" (1/2 NPT)	3.90 [99]	3.43 [87]	0.61 [16]	1.38 [35]	1.22 [44]

### Standard Ranges\*

Pressure (T)			
Range Code	Specific Range	Figure Intervals	Minor Divisions
645	0/10 in. H <sub>2</sub> O	1	0.1
650	0/15 in. H <sub>2</sub> O	5	0.2
660	0/30 in. H <sub>2</sub> O	5	0.5
670	0/60 in. H <sub>2</sub> O	10	1
680	0/100 in. H <sub>2</sub> O	10	1
690	0/160 in. H <sub>2</sub> O	20	2
700	0/200 in. H <sub>2</sub> O	20	2
720	0/300 in. H <sub>2</sub> O	50	5
652	0/10 oz./in. <sup>2</sup>	1	0.1
655	0/15 oz./in. <sup>2</sup>	5	0.2
662	0/20 oz./in. <sup>2</sup> & 0/34 in. H <sub>2</sub> O	5	1
667	0/30 oz./in. <sup>2</sup>	5	0.5
675	0/60 oz./in. <sup>2</sup>	10	1
695	0/100 oz./in. <sup>2</sup>	10	1
725	0/160 oz./in. <sup>2</sup>	20	2
750	0/250 oz./in. <sup>2</sup>	50	5
675	0/3 psi	0.5	0.05
685	0/5 psi	1	0.1
715	0/10 psi	1	0.1

### Standard Ranges\*

Vacuum (W)			
Range Code	Specific Range	Figure Intervals	Minor Divisions
580	15/0 in. H <sub>2</sub> O	5	0.2
600	30/0 in. H <sub>2</sub> O	5	0.5
610	60/0 in. H <sub>2</sub> O	10	1
620	100/0 in. H <sub>2</sub> O	10	1
635	200/0 in. H <sub>2</sub> O	20	2
595	15/0 oz./in. <sup>2</sup>	5	0.2
605	30/0 oz./in. <sup>2</sup>	5	0.5
620	60/0 oz./in. <sup>2</sup>	10	1
633	100/0 oz./in. <sup>2</sup>	10	1

\* Compound ranges are also available. Please consult factory.

SPECIALTY GAUGES

# 766SS

## Low Pressure Gauge • Stainless Steel Case

SPECIALTY GAUGES



766SS shown



- ▶ **2 1/2", 4", 6" Dial Sizes**
- ▶ **±1.6% Accuracy (2 1/2", 4")**
- ▶ **±2.0% Accuracy (6")**
- ▶ **Stainless Steel Case**

The Trerice **766SS Series** Low Pressure Gauge is designed to accurately measure extreme low pressure conditions. This pressure gauge employs a diaphragm capsule sensing element to measure the low pressure. Case material and wetted parts are stainless steel.

- Optional features and case style variations available: Please consult the Options & Accessories Section for details.
- For correct use and application of all pressure gauges, please refer to: Pressure Gauge Standard ASME B40.100.

### Specifications

<b>Model</b>	<b>766SS</b>
<b>Dial Sizes</b>	2 1/2", 4", 6"
<b>Wetted Parts</b>	316L stainless steel diaphragm capsule, 316 stainless steel socket
<b>Movement</b>	316 Stainless Steel
<b>Connection</b>	Lower male or center back male, 1/4 or 1/2 NPT
<b>Case</b>	304 stainless steel, satin finished, stem-mounted flangeless
<b>Ring</b>	Bayonet type, 304 stainless steel
<b>Window</b>	Clear glass
<b>Pointer</b>	Plain, black finished
<b>Dial Face</b>	Aluminum, white background with black graduations and markings
<b>Accuracy</b>	2 1/2" Dial Size: ±1.6% Full Scale 4" Dial Size: ±1.6% Full Scale 6" Dial Size: ±2.0% Full Scale
<b>Maximum Temperature</b>	<b>212°F (100°C)</b>
<b>Approximate Shipping Weight</b>	2 1/2" Dial Size: 0.3 lbs [0.14 kg] 4" Dial Size: 1.4 lbs [0.64 kg] 6" Dial Size: 1.9 lbs [0.86 kg]

### HOW TO ORDER

Sample Order Number: **766SS 40 02 L W 600**

Model	Dial Size	Connection Size	Connection Location	Units of Measure	Range Code
<b>766SS</b>	<b>25</b> 2 1/2"	<b>02</b> 1/4 NPT	<b>L</b> Lower	<b>T</b> Pressure	See Standard Ranges
	<b>40</b> 4"	<b>04</b> 1/2 NPT*	<b>B</b> Back	<b>W</b> Vacuum	
	<b>60</b> 6"				

\* Not available with 2 1/2" dial size.



# 766SS

All dimensions are nominal. Dimensions in [ ] are in millimeters.

## Low Pressure Gauge • Stainless Steel Case

SPECIALTY GAUGES

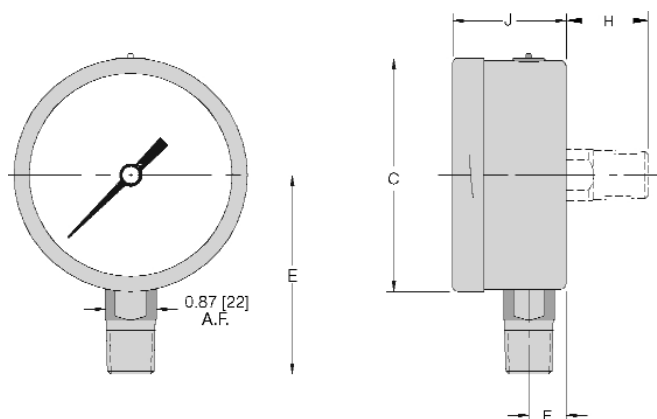

Dial Size	C	E	F	H	J
2 1/2"	2.48 [63]	2.09 [53]	0.43 [11]	1.06 [27]	1.46 [37]
4"	3.98 [101]	3.43 [87]	0.63 [16]	1.38 [35]	1.93 [49]
6"	6.34 [161]	4.76 [121]	0.69 [18]	1.38 [35]	1.97 [50]

### Standard Ranges\*

Pressure (T)			
Range Code	Specific Range	Figure Intervals	Minor Divisions
645	0/10 in. H <sub>2</sub> O	1	0.1
650	0/15 in. H <sub>2</sub> O	5	0.2
660	0/30 in. H <sub>2</sub> O	5	0.5
670	0/60 in. H <sub>2</sub> O	10	1
680	0/100 in. H <sub>2</sub> O	10	1
690	0/160 in. H <sub>2</sub> O	20	2
700	0/200 in. H <sub>2</sub> O	20	2
720	0/300 in. H <sub>2</sub> O	50	5
652	0/10 oz./in. <sup>2</sup>	1	0.1
655	0/15 oz./in. <sup>2</sup>	5	0.2
662	0/20 oz./in. <sup>2</sup> & 0/34 in.H <sub>2</sub> O	5	1
667	0/30 oz./in. <sup>2</sup>	5	0.5
675	0/60 oz./in. <sup>2</sup>	10	1
695	0/100 oz./in. <sup>2</sup>	10	1
725	0/160 oz./in. <sup>2</sup>	20	2
750	0/250 oz./in. <sup>2</sup>	50	5
675	0/3 psi	0.5	0.05
685	0/5 psi	1	0.1
715	0/10 psi	1	0.1

### Standard Ranges\*

Vacuum (W)			
Range Code	Specific Range	Figure Intervals	Minor Divisions
580	15/0 in. H <sub>2</sub> O	5	0.2
600	30/0 in. H <sub>2</sub> O	5	0.5
610	60/0 in. H <sub>2</sub> O	10	1
620	100/0 in. H <sub>2</sub> O	10	1
635	200/0 in. H <sub>2</sub> O	20	2
595	15/0 oz./in. <sup>2</sup>	5	0.2
605	30/0 oz./in. <sup>2</sup>	5	0.5
620	60/0 oz./in. <sup>2</sup>	10	1
633	100/0 oz./in. <sup>2</sup>	10	1

\* Compound ranges are also available. Please consult factory.

# 700TA Series

## Sanitary Gauge with Integrated Diaphragm Seal

SPECIALTY GAUGES



700TA shown



2 1/2", 4" Dial Sizes

Stainless Steel Case

Liquid Fillable

1 1/2", 2" Tri-clamp Type Connections

The Trerice **700TA Series** Sanitary Gauge is 3A approved and especially suited for use in the dairy and food processing industries. This field liquid fillable (no kit required) gauge has a stainless steel case, ring, and process housing. All wetted parts are stainless steel.

- Optional features and case style variations available: Please consult the Options & Accessories Section for details.
- Please refer to 3A Standard 37-01, 3A Standard for Liquid Pressure and Level Sensing Devices
- For correct use and application of all pressure gauges, please refer to: Pressure Gauge Standard ASME B40.100.

### HOW TO ORDER

Sample Order Number: **700TA 40 15T L A 130**

Model	Dial Size	Connection Size	Connection Location	Units of Measure	Range Code
700TA	25 2 1/2"	15T 1 1/2" Tri-Clamp	L Lower	A psi	See Standard Ranges
700TALF	40 4"	20T 2" Tri-Clamp	B Back	D psi/kPa	

### Specifications

#### Models

700TA (dry)  
700TALF (liquid filled)

**Dial Sizes** 2 1/2", 4"

#### Wetted Parts

316 stainless steel diaphragm

#### Fill

Glycerine, other fills available. See Options & Accessories.

#### Movement

Stainless steel

#### Connection

2 1/2" Dial Size: Lower or center back Tri-clamp, 1 1/2" or 2"  
4" Dial Size: Lower or lower back, Tri-clamp, 1 1/2" or 2"

#### Case

304 stainless steel, stem mounted flangeless

#### Ring

Crimped 304 stainless steel, highly polished

#### Window

Safety glass

#### Pointer

Plain black finished

#### Dial Face

Aluminum, white background with black graduations and markings

#### Accuracy

±1.6% Full Scale

#### Maximum Temperature

250°F (121°C)

#### Approximate Shipping Weight

700TA 2 1/2" Dial Size, 1 1/2" Tri-clamp, 1.4 lbs [0.64 kg]  
700TA 2 1/2" Dial Size, 2" Tri-clamp, 1.9 lbs [0.86 kg]  
700TALF 2 1/2" Dial Size, 1 1/2" Tri-clamp, 1.9 lbs [0.86 kg]  
700TALF 2 1/2" Dial Size, 2" Tri-clamp, 2.6 lbs [1.18 kg]  
700TA 4" Dial Size, 1 1/2" Tri-clamp, 2.6 lbs [1.18 kg]  
700TA 4" Dial Size, 2" Tri-clamp, 3.3 lbs [1.50 kg]  
700TALF 4" Dial Size, 1 1/2" Tri-clamp, 3.3 lbs [1.50 kg]  
700TALF 4" Dial Size, 2" Tri-clamp, 4.0 lbs [1.81 kg]

# 700TA Series

All dimensions are nominal. Dimensions in [ ] are in millimeters.

## Sanitary Gauge with Integrated Diaphragm Seal

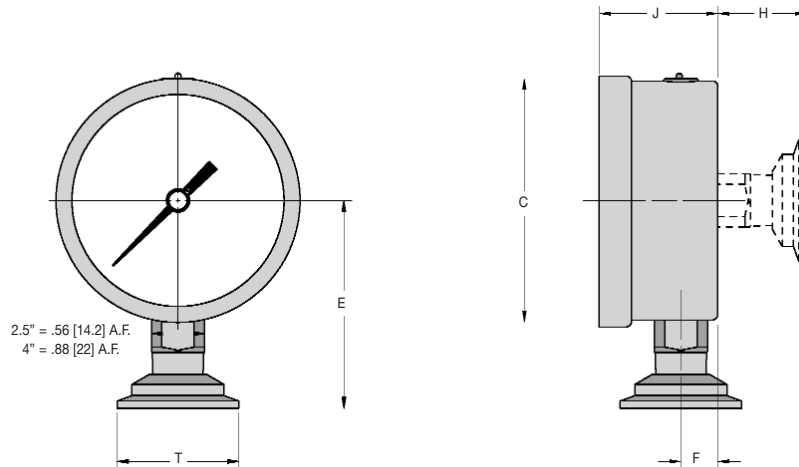

Clamps, gaskets and ferrules are not supplied by Trerice.

SPECIALTY GAUGES

Dial Size	Tri-Clamp Size	C	E	F	H	J	T
2 1/2" [63]	1 1/2"	2.68 [68]	2.64 [67]	0.37 [9.5]	1.52 [38.5]	1.20 [30.5]	1.98 [50.5]
	2"	2.68 [68]	2.64 [67]	0.37 [9.5]	1.52 [38.5]	1.20 [30.5]	2.51 [64.0]
4" [100]	1 1/2"	4.18 [106.2]	3.35 [85]	0.46 [11.8]	1.52 [38.5]	1.32 [33.5]	1.98 [50.5]
	2"	4.18 [106.2]	3.35 [85]	0.46 [11.8]	1.52 [38.5]	1.32 [33.5]	2.51 [64.0]

### Standard Ranges

psi Ranges (A)				psi Ranges (A)		
Range Code	Specific Range	Figure Intervals	Minor Divisions	Range Code	Specific Range	Figure Intervals
010	30" Hg to 0	5	0.5	100	0 to 60 psi	10
020	30" Hg to 15 psi	10/5	10/0.5	110	0 to 100 psi	20
030	30" Hg to 30 psi	10/10	2/1	120	0 to 160 psi	20
040	30" Hg to 60 psi	30/20	2/2	130	0 to 200 psi	50
050	30" Hg to 100 psi	30/20	5/2	140	0 to 300 psi	50
060	30" Hg to 150 psi	30/20	10/2	150	0 to 400 psi	100
070	30" Hg to 300 psi	30/30	5/10	160	0 to 600 psi	100
080	0 to 15 psi	3	0.2	180	0 to 1000 psi	200
090	0 to 30 psi	5	0.5			

For dual scale ranges, specify the appropriate **Units of Measure: D** (psi/kPa) followed by the corresponding **A** (psi) **Range Code**. Other pressure ranges are also available including: Altitude, Ammonia, Refrigerant and Receiver. Consult Special Application Ranges section or factory for availability.

# 700Plus Series

## Industrial Transmitter Gauge

SPECIALTY GAUGES



703SS shown



- ▶ 4" Dial Size
- ▶  $\pm 1.0\%$  Accuracy
- ▶ Stainless Steel Case
- ▶ Liquid Fillable

The Trerice **700Plus Series** Transmitter Gauge is designed to provide both local and remote pressure readings through the integration of an independent pressure transmitter to the pressure gauge. This gauge has a stainless steel case and ring, and is field liquid fillable (no kit required). Wetted parts include a stainless steel tube and socket with a ceramic transmitter.

- Optional features and case style variations available: Please consult the Options & Accessories Section for details.
- For correct use and application of all pressure gauges, please refer to: Pressure Gauge Standard ASME B40.100.

### Specifications

#### Models

703SS (dry)  
703LFSS (liquid filled)

#### Dial Size

4"

#### Wetted Parts

Transmitter: Ceramic  
Gauge: 316L stainless steel tube & socket

#### Fill

Mineral Oil

#### Movement

Stainless Steel

#### Process Connection

Lower male or lower back male, 1/4 or 1/2 NPT

#### Case

304 Stainless steel, stem mounted flangeless

#### Ring

Bayonet type, 304 stainless steel

#### Window

Clear glass

#### Pointer

Micro adjustable knife edge, black finished

#### Dial Face

Aluminum, white background with black graduations and markings

#### Electrical Connection

Wiring cable

#### Supply Voltage

12 to 28 Vdc @ 6mA  
(15 to 28 Vdc with 0 to 10 Vdc Output Signal)

#### Output Signal

4 to 20 mA  
(load resistance maximum  $\Omega$ ) =  $\frac{V_{\text{supply}} - 12}{0.02}$

#### Accuracy

Transmitter:  $\pm 0.3\%$  Full Scale Max.  
Gauge:  $\pm 1.0\%$  Full Scale, ASME B40.100 Grade 1A

#### Maximum Temperature

212°F (100°C)

#### Approximate Shipping Weight

2.0 lbs [0.91 kg]

### HOW TO ORDER

Sample Order Number: **703SS 40 02 L 2 A 110**

Model	Dial Size	Connection Size	Connection Location	Output Signal	Units of Measure	Range Code
703SS 703LFSS	40 4"	02 1/4 NPT 04 1/2 NPT	L Lower	3 4 to 20 mA	A psi D psi/kPa	See Standard Ranges

# 700Plus Series

## Industrial Transmitter Gauge

All dimensions are nominal. Dimensions in [ ] are in millimeters.

SPECIALTY GAUGES

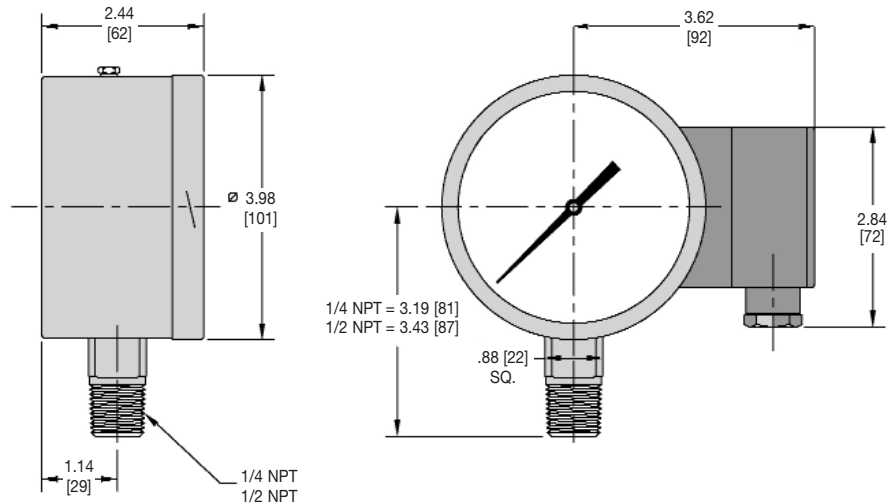

### Standard Ranges

psi Ranges (A)				psi Ranges (A)			
Range Code	Specific Range	Figure Intervals	Minor Divisions	Range Code	Specific Range	Figure Intervals	Minor Divisions
010	30" Hg to 0	5	0.5	120	0 to 160 psi	20	2
020	30" Hg to 15 psi	10/5	0.5/0.5	130	0 to 200 psi	20	2
030	30" Hg to 30 psi	10/5	1/1	140	0 to 300 psi	50	5
040	30" Hg to 60 psi	10/10	2/1	150	0 to 400 psi	50	5
050	30" Hg to 100 psi	30/20	2/2	160	0 to 600 psi	100	10
060	30" Hg to 150 psi	30/20	5/2	180	0 to 1000 psi	100	20
070	30" Hg to 300 psi	30/50	5/5	190	0 to 1500 psi	300	20
080	0 to 15 psi	3	0.2	200	0 to 2000 psi	200	20
090	0 to 30 psi	5	0.5	210	0 to 3000 psi	500	50
100	0 to 60 psi	10	1	220	0 to 5000 psi	1000	100
110	0 to 100 psi	10	2	230	0 to 10,000 psi	2000	200

For dual scale ranges, specify the appropriate **Units of Measure: D** (psi/kPa) followed by the corresponding **A** (psi) **Range Code**. Other pressure ranges are also available including: Altitude, Ammonia, Refrigerant and Receiver. Consult Special Application Ranges section or factory for availability.

# Special Application Ranges

The H.O. Trerice Co. offers a broad spectrum of pressure gauges to satisfy the specialized applications of today's industry. The following Special Application Ranges can be specified on almost all Trerice Pressure Gauges. Please consult Availability Table on page 38.

## Liquid Level Ranges (Altitude)

A Liquid Level range is calibrated to measure feet or meters of H<sub>2</sub>O (water). Gauges with this type of range are usually specified with either an optional red set hand (not available on 8 1/2" or 12" Dial Sizes) or an index pointer (not available on liquid filled gauges). See Options & Accessories section for complete availability. Dual scale ranges with ft H<sub>2</sub>O and corresponding psi scales are available.

### Standard Liquid Level Ranges

psi & Feet of Water Ranges (H)

Range Code	Range	psi		ft H <sub>2</sub> O	
		Figure Intervals	Minor Divisions	Figure Intervals	Minor Divisions
010	30" Hg to 0 / -34 to 0 ft H <sub>2</sub> O	5	0.5	5	0.5
020	30" Hg to 15 psi / -34 to 34 ft H <sub>2</sub> O	10/5	0.5/0.2	5/5	0.5/0.5
030	30" Hg to 30 psi / -34 to 70 ft H <sub>2</sub> O	10/5	0.5/0.5	10/10	1/1
040	30" Hg to 60 psi / -34 to 140 ft H <sub>2</sub> O	10/10	1/1	10/20	2/2
050	30" Hg to 100 psi / -34 to 230 ft H <sub>2</sub> O	30/20	2/1	30/20	2/2
060	30" Hg to 150 psi / -34 to 350 ft H <sub>2</sub> O	30/30	5/2	34/50	2/2
070	30" Hg to 300 psi / -34 to 700 ft H <sub>2</sub> O	30/20	5/2	34/50	10/5
080	0 to 15 psi / 0 to 35 ft H <sub>2</sub> O	3	0.1	5	0.2
090	0 to 30 psi / 0 to 70 ft H <sub>2</sub> O	5	0.2	10	0.5
100	0 to 60 psi / 0 to 140 ft H <sub>2</sub> O	10	0.5	20	1
110	0 to 100 psi / 0 to 230 ft H <sub>2</sub> O	10	1	20	2
120	0 to 160 psi / 0 to 370 ft H <sub>2</sub> O	20	2	40	5
130	0 to 200 psi / 0 to 460 ft H <sub>2</sub> O	20	2	60	4
140	0 to 300 psi / 0 to 700 ft H <sub>2</sub> O	50	2	100	5

Feet of Water Ranges (J)

Range Code	Range	Figure Intervals	Minor Divisions
080	0 to 34 ft H <sub>2</sub> O	5	0.2
090	0 to 70 ft H <sub>2</sub> O	10	0.5
095	0 to 100 ft H <sub>2</sub> O	10	1
100	0 to 140 ft H <sub>2</sub> O	20	1
110	0 to 230 ft H <sub>2</sub> O	20	2
120	0 to 370 ft H <sub>2</sub> O	50	5
130	0 to 460 ft H <sub>2</sub> O	50	5

Meters of Water Ranges (K)

Range Code	Range	Figure Intervals	Minor Divisions
080	0 to 10 m H <sub>2</sub> O	1	0.1
090	0 to 20 m H <sub>2</sub> O	2	0.2
095	0 to 30 m H <sub>2</sub> O	5	0.2
100	0 to 40 m H <sub>2</sub> O	5	0.5
110	0 to 70 m H <sub>2</sub> O	10	0.5
120	0 to 120 m H <sub>2</sub> O	10	1

Other ranges available, consult factory.

# Special Application Ranges

## Ammonia Ranges

An Ammonia Range is calibrated to measure vacuum and pressure (vac/psi) along with the corresponding ammonia temperatures (°F of ammonia). Pressure gauges with this range type require stainless steel wetted parts.

### Standard Ammonia Ranges (P)

Range Code	Range	psi		°F	
		Figure Intervals	Minor Divisions	Figure Intervals	Minor Divisions
310	30" Hg to 150 psi / °F Ammonia	30	2	10	2
320	30" Hg to 300 psi / °F Ammonia	50	2	10	2

Other ranges available, consult factory.

## Refrigerant Ranges

A Refrigerant Range is calibrated to measure vacuum and pressure (vac/psi) along with the corresponding refrigerant temperatures (°F of R).

### Standard Refrigerant Ranges (R)

Range Code	Range	psi		°F	
		Figure Intervals	Minor Divisions	Figure Intervals	Minor Divisions
310	30" Hg to 150 psi / °F R12/R22	25	1	10	2
320	30" Hg to 150 psi / °F R123	30	2	20	5
330	30" Hg to 150 psi / °F R134A	30	2	10	2
340	30" Hg to 300 psi / °F R12/R22	50	2	10	2
350	30" Hg to 300 psi / °F R123	50	2	20	5
360	30" Hg to 300 psi / °F R134A	50	2	20	2

Other ranges available, consult factory.

## Receiver Ranges

A Receiver Range is calibrated to translate the output signal from a 3 to 15 psi pneumatic transmitter into a specified measurement (i.e., temperature, pressure, square root, percent, etc.). Pressure gauges ordered with a receiver range are furnished with a 3 to 15 psi bourdon tube measuring element. **Care should be taken to ensure the maximum pressure never exceeds 15 psi.**

### Standard Receiver Ranges (S)

Range Code	Range	Figure Intervals	Minor Divisions
060	0 to 10 linear	1	0.1
110	0 to 10 sq. rt.	1*	0.1*
370	0 to 100 linear	10	1
440	0 to 100 sq. rt.	10**	1**
420	0 to 100%	10	1

\*Non linear scale, stated interval and division at 3.

\*\*Non linear scale, stated interval and division at 30.

Other ranges available, consult factory.



# Special Application Ranges

## Availability

The following table indicates the special application range availability of Terice Pressure Gauges.

Model	Liquid Level (Altitude)	Ammonia	Refrigerant	Receiver
450B, 450LFB	✓	N/A	✓	✓
450M, 450LFM	✓	N/A	✓	✓
450SS, 450LFSS	✓	✓	✓	✓
500XB	✓	N/A	✓	✓
500XSS	✓	✓	✓	✓
600CB	✓	N/A	✓	✓
610CB	✓	N/A	✓	✓
620B	N/A	N/A	N/A	N/A
690 Series	✓	N/A	✓	✓
700B, 700LFB	✓	N/A	✓	✓
700M, 700LFM	✓	N/A	✓	✓
700Plus	✓	✓	N/A	N/A
700SS, 700LFSS	✓	✓	✓	✓
700TA, 700TALF*	✓	✓	✓	N/A
750M, 750LFM	✓	N/A	✓	✓
750SS, 750LFSS	✓	✓	✓	✓
760B*	N/A	N/A	N/A	N/A
766SS*	N/A	N/A	N/A	N/A
800B	✓	N/A	✓	N/A
800LFB*	✓	N/A	✓	N/A
D82LFB*	✓	N/A	✓	✓
D83LFSS*	✓	✓	✓	✓

\*Red set hand or index pointer not available with these models.

## Specialty Gauge Models

Listed below are Specialty Gauge Models that were previously available. In response to demand, we can now make available a wide number of ranges to customize most Terice Pressure Gauges to suit specific measurement applications. Please order using the current model and specify the range required.

Previous Model	Current Model and Range
435SS	450SS with Ammonia Range
515XB	500XB with Liquid Level Range and Red Set Hand
535XSS	500XSS with Ammonia Range
545XB	500XB with Refrigerant Range
580B	500XB with Receiver Range
615B	500XB with Liquid Level Range and Red Set Hand
615CB	600CB with Liquid Level Range and Red Set Hand
635SS	500XSS with Ammonia Range
645B	500XB with Refrigerant Range
680B	500XB with Receiver Range
775SS	700SS with Ammonia Range

## HOW TO ORDER

Sample Order Number: **500XB 45 02L H 110**

Specify the Units of Measure and Range Code as required.

# Notes

SPECIALTY GAUGES

# Optional Case Styles

## 500X Series

All dimensions are nominal. Dimensions in [ ] are in millimeters.

**How to Order:** Specify the Optional Case Code at the end of the Instrument Ordering Code.

Sample Order Number: **500XB 45 02 L A 110 - FSL**

Optional Case Styles for 500X	Dial Size			
	4 1/2"	6"	8 1/2"	12"
Flangeless, Black Finished, Cast Aluminum Case, Lower Connection	FSL	FSL	N/A	N/A
Flangeless, Black Finished, Cast Aluminum Case, Back Connection	FSB	FSB	N/A	N/A
Panel Mounted, Hinged Ring Case Back Connection	HRB	HRB	N/A	HRB
Panel Mounted, Hinged Ring Case Lower Connection	HRL	HRL	N/A	HRL

N/A = Not available. Please order using the code listed.

### Flangeless

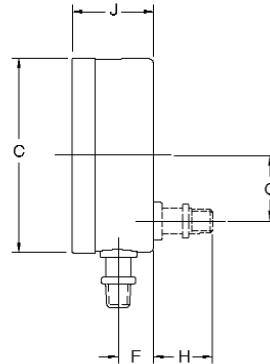
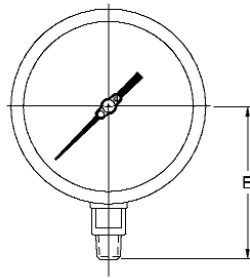

Dial Size	C	E	F	G	H	J
4 1/2"	4.79 [121.7]	3.83 [97.2]	.94 [23.8]	1.63 [41.3]	1.46 [37.1]	2.00 [50.8]
6"	6.29 [159.8]	4.70 [119.5]	.94 [23.8]	1.63 [41.3]	1.46 [37.1]	2.03 [51.6]

### Hinged Ring

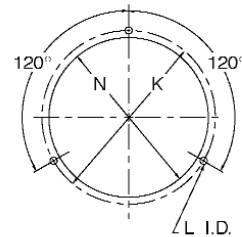
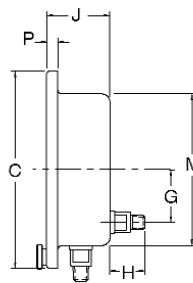
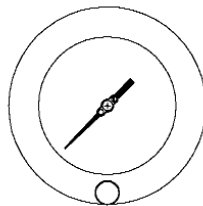

Dial Size	C	G	H	J	K	L	M	N	P
4 1/2"	6.10 [155]	1.62 [41]	1.59 [40]	1.97 [50]	5.38 [136]	0.22 [5]	4.78 [121]	4.94 [125]	0.34 [8]
6"	7.69 [195]	1.62 [41]	1.59 [40]	1.97 [50]	7.00 [177]	0.28 [7]	6.22 [158]	6.44 [163]	0.34 [8]
12"	14.75 [375]	1.62 [41]	1.38 [35]	2.50 [63.5]	13.50 [342]	0.28 [7]	12.50 [317]	12.81 [325]	0.73 [18.5]

# Optional Case Styles

## 600C

All dimensions are nominal. Dimensions in [ ] are in millimeters.

OPTIONS & ACCESSORIES

**Kit Only. Not Factory installed.**

Optional Case Style - 600C	Dial Size	
	3 1/2"	4 1/2"
Surface Mounted Back Flange Kit	115-0222	198-0016

Please order using the code listed.

**3 1/2"** Includes back flange. Use existing screws from gauge.

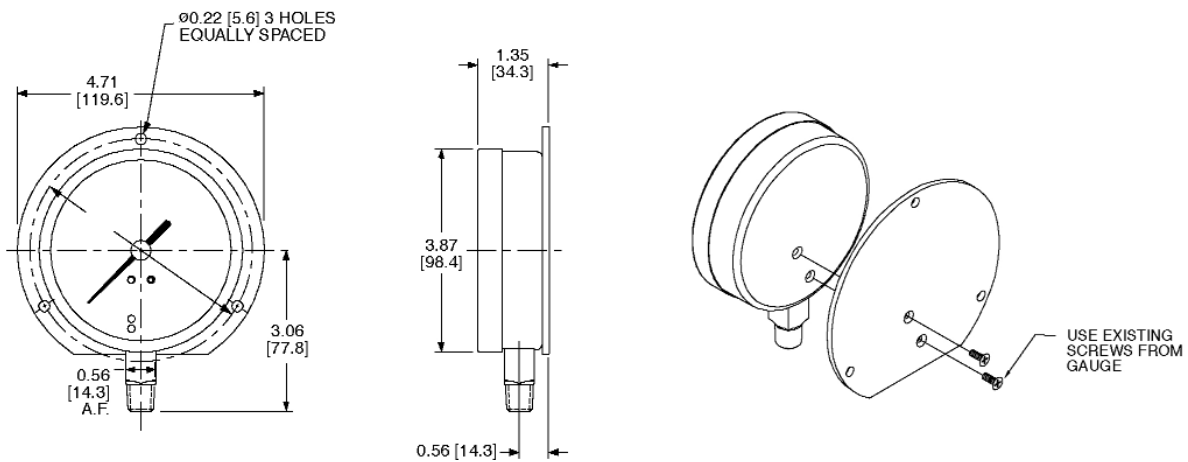

**4 1/2"** Includes back flange and replacement screws.

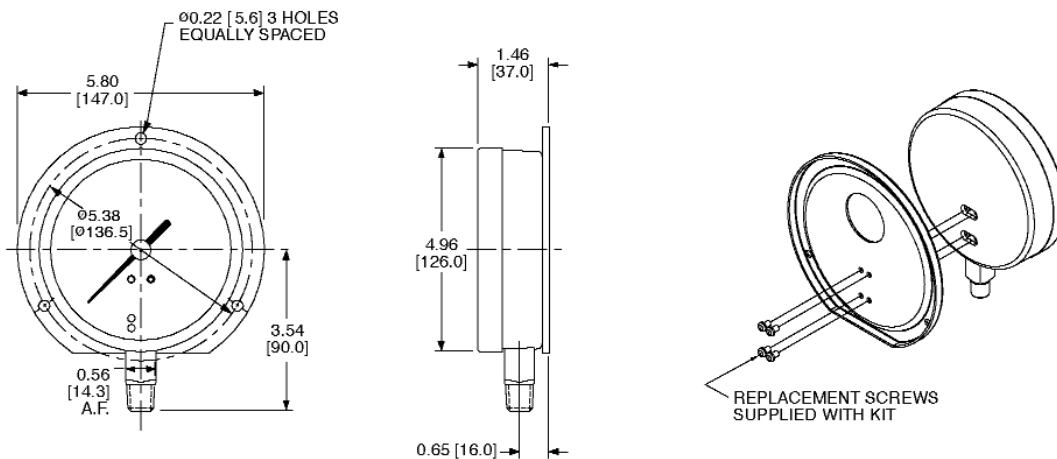

# Optional Case Styles

## 700 Series

All dimensions are nominal. Dimensions in [ ] are in millimeters.

**How to Order:** Specify the Optional Case Code at the end of the Instrument Ordering Code.

**Sample Order Number:** 700SS 40 04 B D 220 - FMB

Case Style - 700 Series	DIAL SIZE		
	2 1/2"	4"	6"
Surface Mounted Case with Back Flange, Lower Connection	N/A	SML	SML
Surface Mounted Case with Back Flange, Back Connection	SMB	SMB	SMB
Flush Mounted Case with Front Flange, Back Connection	FMB	FMB	FMB
Flush Mounted Case with Front Flange, Lower Connection	N/A	FML	FML
Panel Mounted Case with U-Clamp, Back Connection	UCB	UCB	UCB

N/A = Not available. Please order using the code listed.

### 2 1/2", 4" & 6" Surface Mount

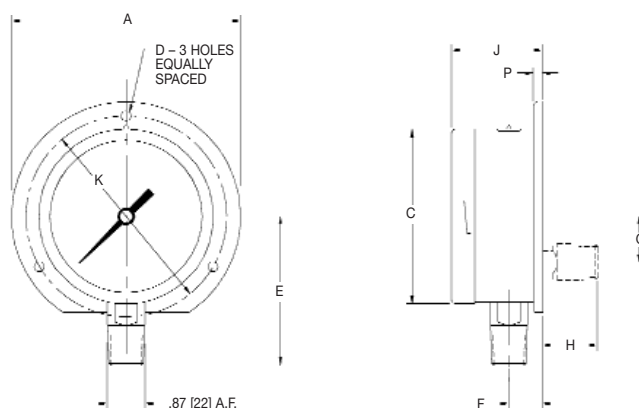

Dial Size	Material	A	C	D	E	F	G	H	J	K	P
2 1/2" [63]	Brass	3.35 [85]	2.52 [64]	0.14 [3.6]	2.22 [56.5]	0.57 [14.5]	0 [0]	0.98 [25]	1.56 [39.5]	2.95 [75]	0.22 [5.5]
	SS	3.35 [85]	2.52 [64]	0.14 [3.6]	2.22 [56.5]	0.57 [14.5]	0 [0]	0.98 [25]	1.56 [39.5]	2.95 [75]	0.22 [5.5]
4" [100]	Brass	5.20 [132]	3.98 [101]	0.19 [5]	3.39 [86]	0.75 [19]	1.04 [27]	1.32 [34]	2.07 [53]	4.57 [116]	0.22 [5.5]
	SS	5.20 [132]	3.98 [101]	0.19 [5]	3.39 [86]	0.75 [19]	1.36 [35]	1.26 [32]	2.07 [53]	4.57 [116]	0.22 [5.5]
6" [150]	Brass	7.72 [196]	6.34 [161]	0.23 [6]	4.57 [116]	0.81 [21]	1.04 [27]	1.32 [34]	2.09 [53]	7.01 [178]	0.24 [6]
	SS	7.72 [196]	6.34 [161]	0.23 [6]	4.57 [116]	0.81 [21]	1.36 [35]	1.26 [32]	2.09 [53]	7.01 [178]	0.24 [6]

### 2 1/2" Front Flange

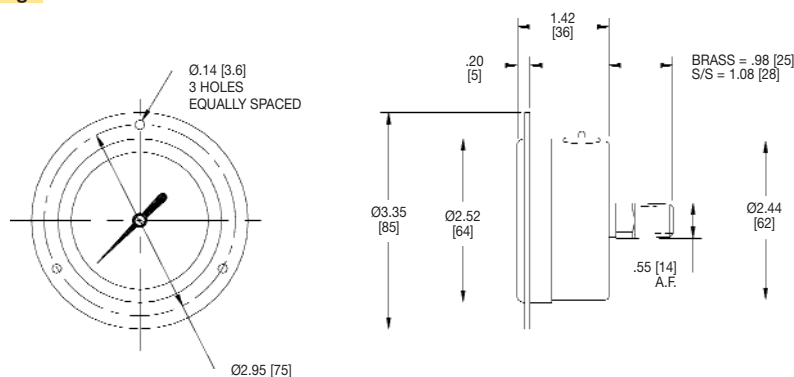

# Optional Case Styles

## 700 Series

All dimensions are nominal. Dimensions in [ ] are in millimeters.

### 4" & 6" Front Flange

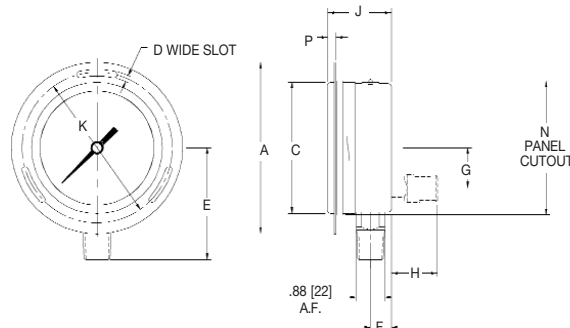

Dial Size	Material	A	C	D	E	F	G	H	J	K	N	P
4" [100]	Brass	5.20 [132]	3.98 [101]	0.19 [5]	3.39 [86]	0.63 [16]	1.04 [27]	1.44 [37]	1.93 [49]	4.57 [116]	4.13 [105]	0.24 [6]
	SS	5.20 [132]	3.98 [101]	0.19 [5]	3.39 [86]	0.63 [16]	1.36 [35]	1.38 [35]	1.93 [49]	4.57 [116]	4.13 [105]	0.24 [6]
6" [150]	Brass	7.72 [196]	6.34 [161]	0.23 [6]	4.57 [116]	0.69 [18]	1.04 [27]	1.44 [37]	1.97 [50]	7.01 [178]	6.50 [165]	0.24 [6]
	SS	7.72 [196]	6.34 [161]	0.23 [6]	4.57 [116]	0.69 [18]	1.36 [35]	1.38 [35]	1.97 [50]	7.01 [178]	6.50 [165]	0.24 [6]

### 2 1/2" U-Clamp

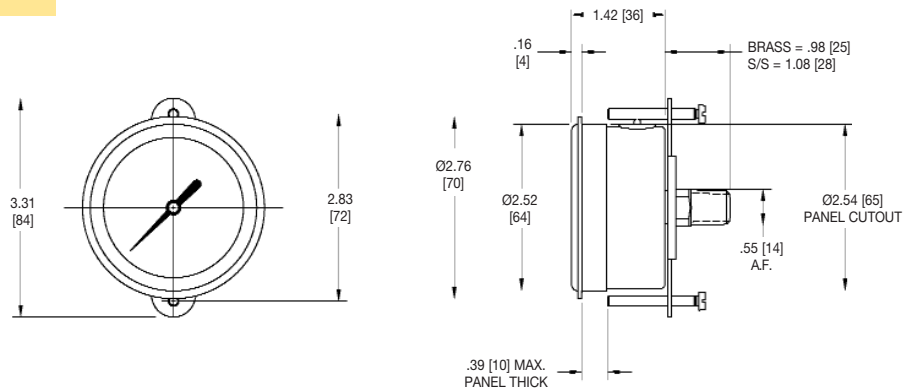

### 4" & 6" U-Clamp

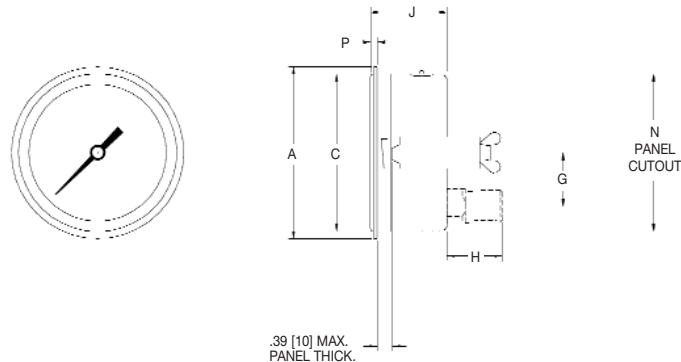

Dial Size	Material	A	C	G	H	J	N	P
4" [100]	Brass	4.33 [110]	3.98 [101]	1.04 [27]	1.44 [37]	1.93 [49]	4.02 [102]	0.18 [5]
	SS	4.33 [110]	3.98 [101]	1.36 [35]	1.38 [35]	1.93 [49]	4.02 [102]	0.18 [5]
6" [150]	Brass	6.69 [170]	6.34 [161]	1.04 [27]	1.44 [37]	1.97 [50]	6.39 [162]	0.24 [6]
	SS	6.69 [170]	6.34 [161]	1.36 [35]	1.38 [35]	1.97 [50]	6.39 [162]	0.24 [6]

# Optional Case Styles

## 760B & 766SS

All dimensions are nominal. Dimensions in [ ] are in millimeters.

**How to Order:** Specify the Optional Case Code at the end of the Instrument Ordering Code.

**Sample Order Number:** 766SS 60 02 L M 660 - SML

### Optional Case Styles for 760B & 766SS

	760B	760B	766SS	766SS
	2 1/2"	4"	4"	6"
Surface Mounted Case with Back Flange, Lower Connection	N/A	N/A	SML	SML
Surface Mounted Case with Back Flange, Back Connection	N/A	N/A	SMB	SMB
Flush Mounted Case with Front Flange, Back Connection	FMB	FMB	FMB	FMB
Flush Mounted Case with Front Flange, Lower Connection	N/A	N/A	FML	FML
Panel Mounted Case with U-Clamp, Back Connection	UCB*	N/A	UCB	UCB

N/A = Not available. Please order using the code listed.

\*Supplied with stainless steel case.

### 766SS

#### 4" & 6" Surface Mount

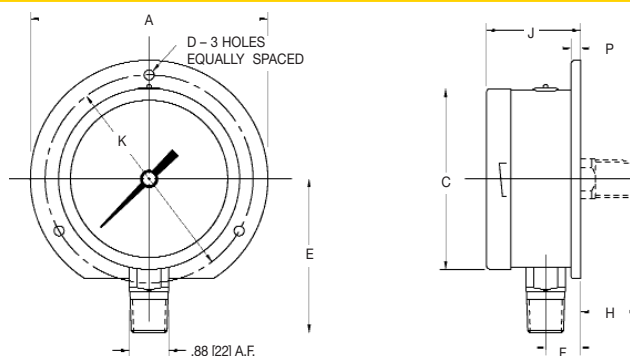

Dial Size	A	C	D	E	F	H	J	K	P
4" [100]	5.20 [132]	3.98 [101]	.19 [5]	3.43 [87]	.75 [19]	1.26 [32]	2.07 [53]	4.57 [116]	.22 [5.5]
6" [150]	7.72 [196]	6.34 [161]	.23 [6]	4.84 [123]	.81 [21]	1.26 [32]	2.09 [53]	7.01 [178]	.22 [5.5]

### 760B

#### 2 1/2" Front Flange

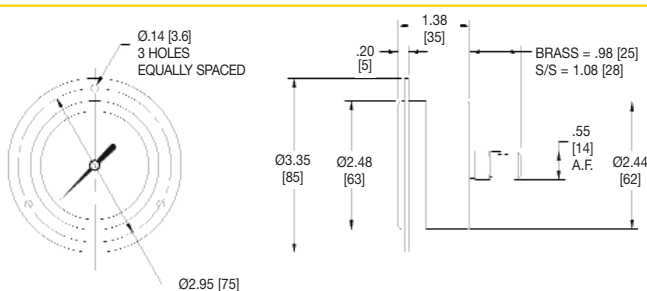



# Optional Case Styles

## 760B & 766SS

All dimensions are nominal. Dimensions in [ ] are in millimeters.

OPTIONS & ACCESSORIES

### 760B

#### 4" Front Flange

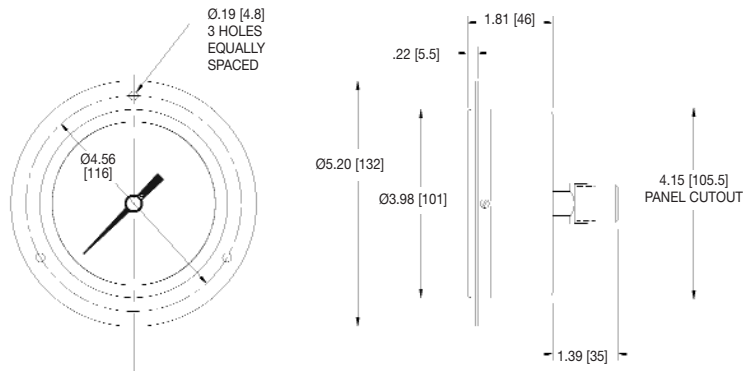

### 766SS

#### 4" & 6" Front Flange

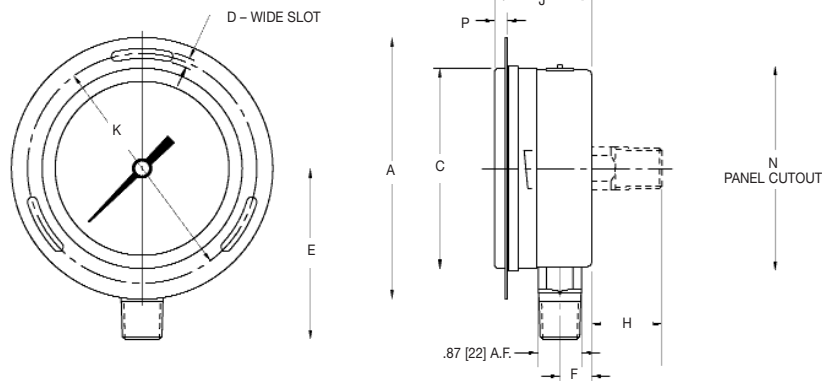

Dial Size	Material	A	C	D	E	F	H	J	K	N	P
4" [100]	Brass	5.20 [132]	3.98 [101]	.19 [5]	3.43 [87]	0.63 [16]	1.38 [35]	1.93 [49]	4.57 [116]	4.13 [105]	0.24 [6]
	SS	5.20 [132]	3.98 [101]	.19 [5]	3.43 [87]	0.63 [16]	1.38 [35]	1.93 [49]	4.57 [116]	4.13 [105]	0.24 [6]
6" [150]	Brass	7.72 [196]	6.34 [161]	.23 [6]	4.76 [121]	0.69 [18]	1.38 [35]	1.97 [50]	7.01 [178]	6.50 [165]	0.24 [6]
	SS	7.72 [196]	6.34 [161]	.23 [6]	4.84 [123]	0.69 [18]	1.38 [35]	1.97 [50]	7.01 [178]	6.50 [165]	0.24 [6]

### 760B & 766SS

#### 2 1/2" U-Clamp\*

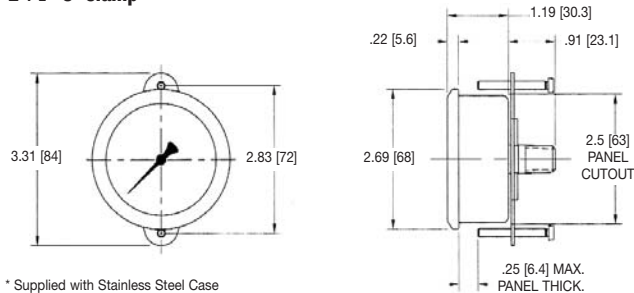

\* Supplied with Stainless Steel Case

### 766SS

#### 4" & 6" U-Clamp

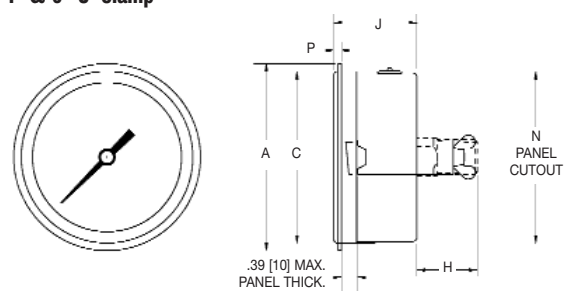

Dial Size	Material	A	C	H	J	N	P
4" [100]	Brass	4.33 [110]	3.98 [101]	1.44 [37]	1.93 [49]	4.02 [102]	0.18 [5]
	SS	4.33 [110]	3.98 [101]	1.38 [35]	1.93 [49]	4.02 [102]	0.18 [5]
6" [150]	Brass	6.69 [170]	6.34 [161]	1.44 [37]	1.97 [50]	6.39 [162]	0.24 [6]
	SS	6.69 [170]	6.34 [161]	1.38 [35]	1.97 [50]	6.39 [162]	0.24 [6]

# Optional Case Styles

## D80 Series

All dimensions are nominal. Dimensions in [ ] are in millimeters.

**How to Order:** Specify the Optional Case Code at the end of the Instrument Ordering Code.

**Sample Order Number:** **D82LFB 25 02 L A 160 - SML**

Case Style - D80 Series	Dial Size		
	2"	2 1/2"	4"
Surface Mounted, Back Flange Case for Lower Connection	N/A	SML	SML
* Panel Mounted, Front Flange Kit for Back Connection	198-0028	198-0025	198-0027
* Panel Mounted, Front Ring Kit for Back Connection	N/A	198-0024	N/A
* Panel Mounted, U-Clamp Kit for Back Connection	198-0031	198-0026	198-0029

\* **Kit Only. Not Factory installed.**

### 2 1/2" & 4" Surface Mount

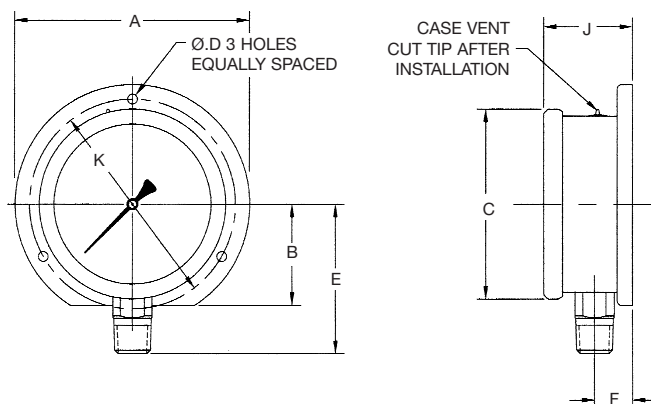

Dial Size	A	B	C	D	E	F	J	K
2 1/2"	3.35 [85]	1.43 [36.3]	2.68 [68]	0.14 [3.6]	2.23 [56.6]	0.52 [13.2]	1.38 [35.1]	2.95 [75]
4"	5.20 [132]	2.19 [55.6]	4.18 [106]	0.19 [4.8]	3.07 [78]	0.62 [15.7]	1.47 [37.3]	4.57 [116]

### 2", 2 1/2" & 4" Front Flange

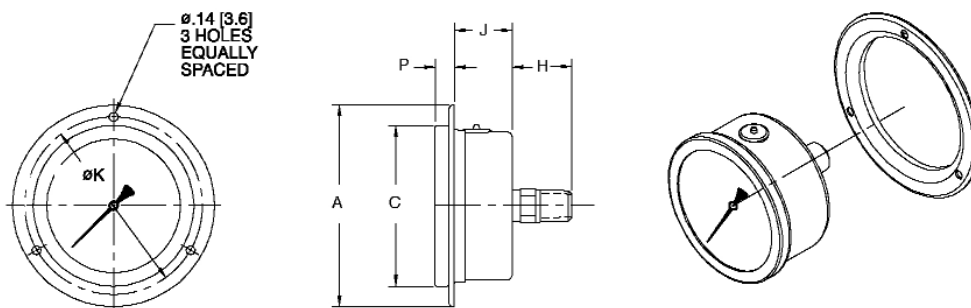

Dial Size	A	C	H	J	K	P
2"	3.03 [77]	2.09 [53]	0.99 [25]	0.94 [24]	2.65 [65]	0.32 [8]
2 1/2"	3.35 [85]	2.67 [68]	0.99 [25]	0.82 [21]	2.95 [75]	0.32 [8]
4"	5.20 [132]	4.17 [106]	0.99 [25]	0.91 [23]	4.56 [116]	0.42 [10]

# Optional Case Styles

## D80 Series

All dimensions are nominal. Dimensions in [ ] are in millimeters.

OPTIONS & ACCESSORIES

### 2 1/2" Front Ring

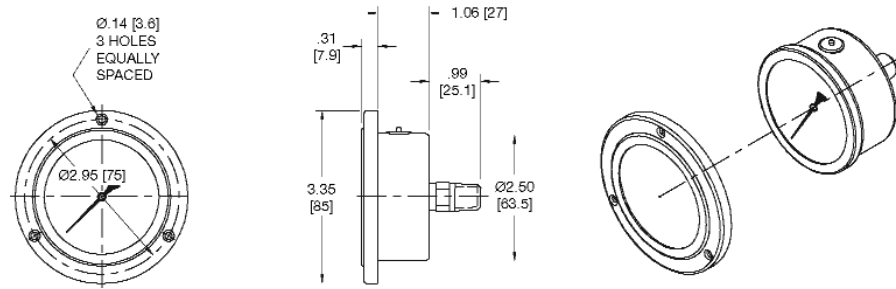

### 2", 2 1/2" & 4" U-Clamp

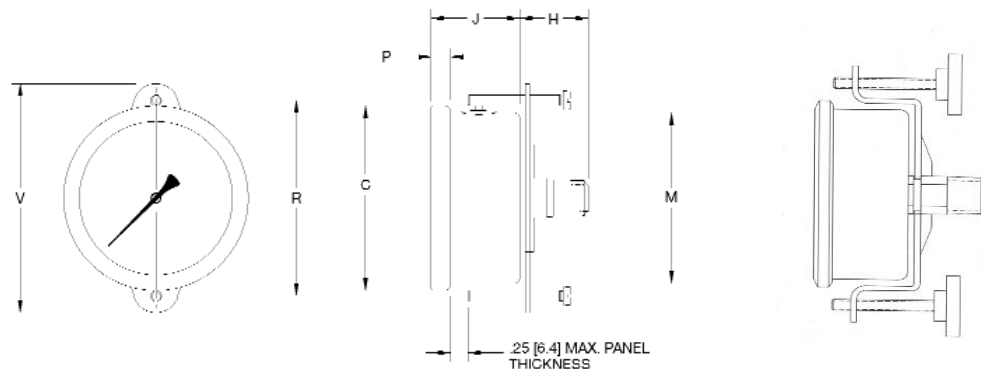

Dial Size	C	H	J	M	P	R	V
2"	2.09 [53]	.99 [25]	1.10 [28]	1.91 [48.5]	.18 [4.5]	2.28 [58]	2.76 [70]
2 1/2"	2.68 [68]	.99 [25]	1.20 [30.5]	2.44 [62]	.28 [7]	2.83 [72]	3.31 [84]
4"	4.17 [106]	.99 [25]	1.32 [33.5]	3.88 [98.6]	.28 [7]	4.33 [110]	4.80 [122]

# Optional Case Styles

## 800 Series

All dimensions are nominal. Dimensions in [ ] are in millimeters.

**How to Order:** Specify the Optional Case Code at the end of the Instrument Ordering Code.

**Sample Order Number:** 800B 15 01 B D 140 - UCB

Case Styles - 800 Series	Dial Size			
	1 1/2"	2"	2 1/2"	4"
Panel Mounted Case with Front Flange, Back Connection	FMB	FMB	FMB	FMB
Panel Mounted Case with U-Clamp, Back Connection	UCB	UCB	UCB	N/A

Please order using the code listed.

### Front Flange

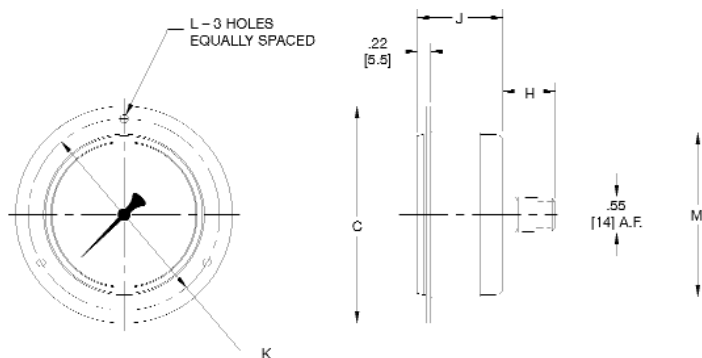

Dial Size	C	H	J	K	L	M
1 1/2"	2.40 [61]	0.73 [18.5]	0.98 [25]	1.97 [50]	.14 [3.5]	1.61 [41]
2"	2.80 [71]	0.83 [21]	1.02 [26]	2.36 [60]	.14 [3.5]	1.97 [50]
2 1/2"	3.35 [85]	0.83 [21]	1.06 [27]	2.95 [75]	.14 [3.5]	2.52 [64]
4"	5.20 [132]	0.98 [25]	1.26 [32]	4.57 [116]	.19 [4.8]	3.96 [100.5]

### 1 1/2", 2", 2 1/2" U-Clamp

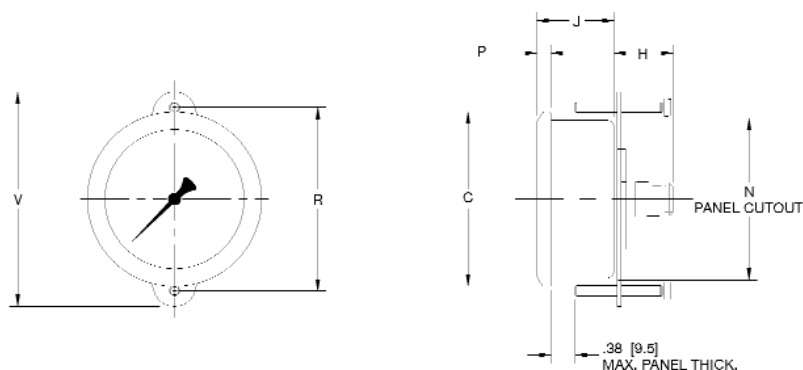

Dial Size	C	H	J	N	P	R	V
1 1/2"	1.73 [44]	1.08 [27.5]	1.12 [28.5]	1.57 [40]	0.24 [6]	1.97 [50]	2.44 [62]
2"	2.13 [54]	1.02 [26]	1.18 [30]	1.97 [50]	0.22 [5.5]	2.28 [58]	2.76 [70]
2 1/2"	2.68 [68]	1.02 [26]	1.18 [30]	2.48 [63]	0.22 [5.5]	2.83 [72]	3.31 [84]

# Optional Case Styles

## 800LF Series

All dimensions are nominal. Dimensions in [ ] are in millimeters.

**How to Order:** Specify the Optional Case Code at the end of the Instrument Ordering Code.

**Sample Order Number:** **800LFB 35 02 B A 030 - UCB**

Case Styles - 800LF Series	Dial Size	
	2 1/2"	3 1/2"
* Panel Mounted, Front Flange Kit for Back Connection	198-0020	N/A
* Surface Mounted, Back Flange Kit for Lower Connection	198-0022	N/A
* Panel Mounted, Front Ring Kit for Back Connection	198-0021	N/A
* Panel Mounted, U-Clamp Kit for Back Connection	198-0026	N/A
Panel Mounted Case with U-Clamp, Back Connection	N/A	UCB

**\* Kit Only. Not Factory installed.**

*Please order using the code listed.*

OPTIONS & ACCESSORIES

### 2 1/2" Front Flange

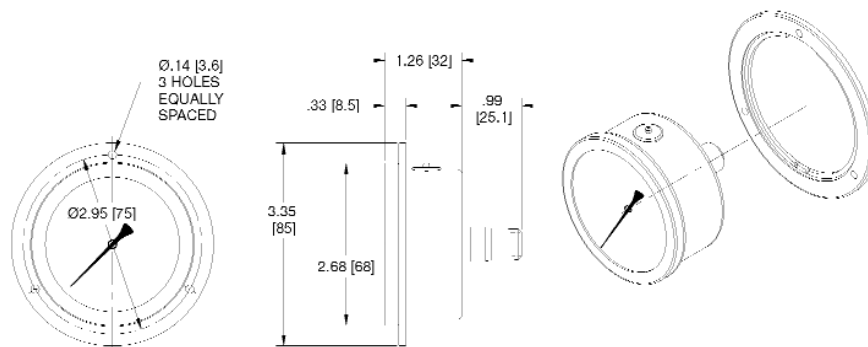

### 2 1/2" Back Flange

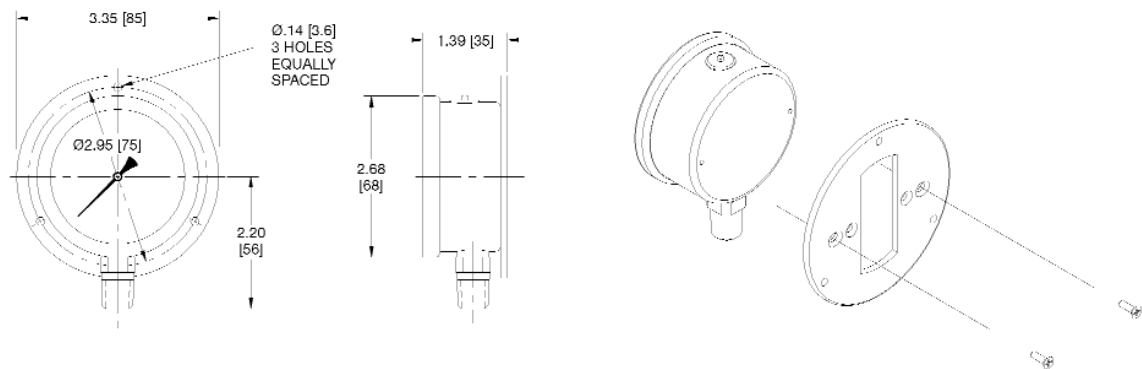

# Optional Case Styles

## 800LF Series (continued)

All dimensions are nominal. Dimensions in [ ] are in millimeters.

### 2 1/2" Front Ring

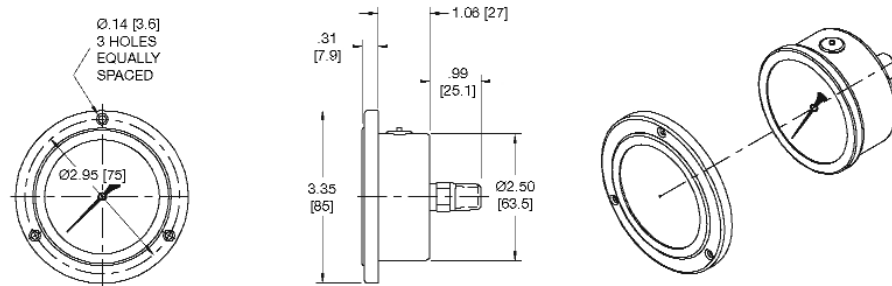

### 2 1/2" U-Clamp

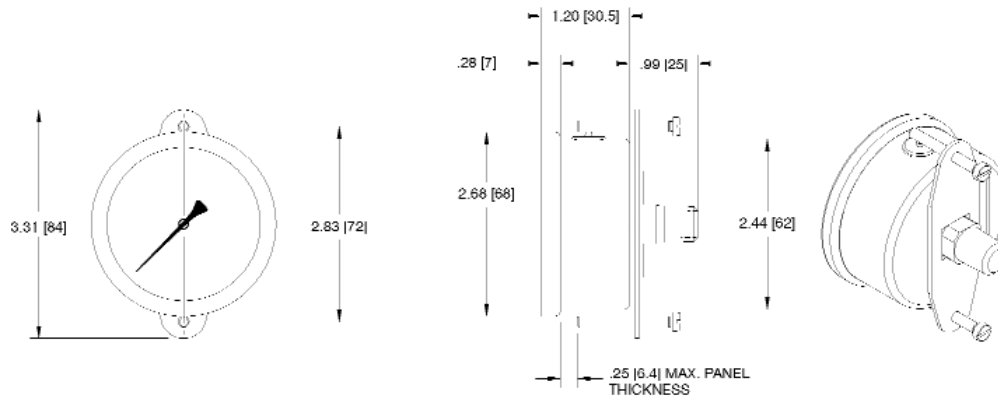

### 3 1/2" U-Clamp

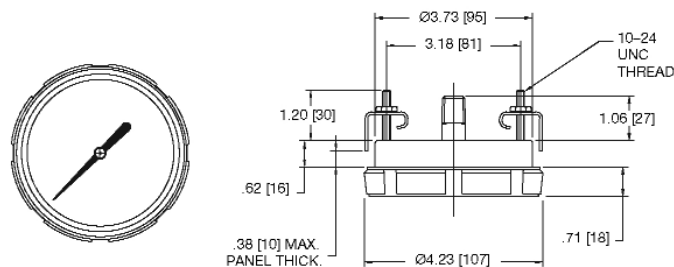

# Optional Features

## PRESSURE GAUGES

### Windows (PLW/SGW)

Trerice offers a complete line of window options, including: plastic (acrylic) and laminated safety glass. Please consult the Option Application Table for window availability. Replacement windows are sold separately; please consult the price sheet for item numbers.

### Red Set Hand (RSH)

Attached at the center of the dial face, a red set hand can be adjusted to indicate a desired predetermined reference point. The set point is adjusted by removing the ring and window of the gauge (dry gauge only). When used on a liquid filled gauge, please specify the set point when ordering. Please consult the Option Application Table for set hand availability.

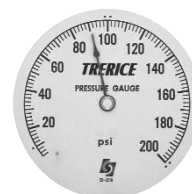

### Maximum Registering Pointers (MAX)

Maximum registering pointers can be furnished on most dry 3 1/2" dial size and larger pressure gauges having a pressure range of 60 psi or greater. The pointer is designed to indicate the maximum or minimum pressure attained by the process being measured since the pointer was last reset. The pointer assembly is installed to an acrylic window, with an external knob for manually resetting the pointer. Please consult the Option Application Table for maximum registering pointer availability.



### Electric Contacts

Electric contact assemblies can be supplied on most 4", 4 1/2" and 6" pressure gauges. These units are well suited for making the electrical contact required to activate alarms, signals, or other electrical devices. Each unit is provided with an external adjustment key, making it easy to adjust and providing for tamper-resistant operation. The contacts have adjustable magnets to eliminate pointer bounce caused by vibration, and have pass/repass capability, allowing the pointer to move past the set point while maintaining contact. For applications that require a liquid-filled gauge, a special inductive type contact is required. Please consult factory for additional information.



#### Electric Contact Configurations

Optional Feature Code	Contact Style	Contact Action
EC1	Single High	Single contact: Makes on clockwise rotation
EC2	Single Low	Single contact: Breaks on clockwise rotation
EC3	High-Low	Double contact: High contact makes on clockwise rotation Low contact breaks on clockwise rotation
EC4	Double High	Double contact: 1st makes on clockwise rotation 2nd makes on clockwise rotation

Please consult the Option Application Table for electric contact availability.

#### Recommended Load Limits

Volts	Resistive	Inductive
110 Vac	0.25 A	0.13 A
24 Vdc	0.40 A	0.25 A



# Optional Features

## PRESSURE GAUGES

### Weatherproofed Cases (WPC)

Trerice pressure gauges may be sealed for outdoor use, or for use in applications where sprays and washes will come in contact with the gauge. Trerice Series 450, 700, 750 and all liquid-filled gauges are hermetically sealed and are inherently weatherproof. The weatherproofing option is available for most other pressure gauges.

### Pressure Relief Plugs (PRP)

This feature is designed to release non-instantaneously developed internal case pressure at 3 to 5 psi, and can be supplied on most 3 1/2" and larger pressure gauges. Please consult the Option Application Table for pressure relief plug availability.



### Silicone Dampened Movements (SDM)

The application of a highly viscous silicone oil to the gear, sector, and all bearing points of the movement will help reduce the effects of vibration and pulsation to which the gauge may be subjected. This feature will extend the life of the gauge by reducing wear on the movement, and is available on most Trerice Pressure Gauges. Please consult the Option Application Table for silicone dampened movement availability.

### Capillary Tube Bleeders (CTB)

The No. 421 Capillary Bleeder has been designed as an accessory for the 500X Series Pressure Gauge. This feature makes it possible to completely eliminate air or other pressure media that may be trapped in the bourdon tube of a gauge. After installation, the bleeder must be opened to allow the entrapped air or medium to be purged from the bourdon tube. After purging, the bleeder can be closed, permitting proper action of the gauge. When used on a 500XB gauge, the bleeder assembly is manufactured from brass, and has a maximum pressure of 1000 psi. When used on a 500XSS gauge, the bleeder assembly is manufactured from 347 stainless steel, and has a maximum pressure of 5000 psi. Please consult the Option Application Table for capillary bleeder availability.

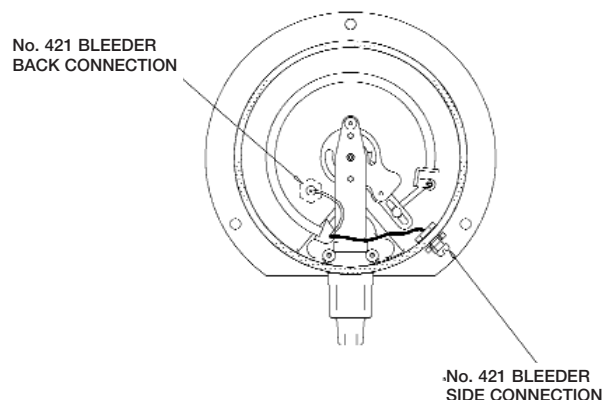

# Optional Features

## PRESSURE GAUGES

### Snubber Screws and Restrictors

A snubber screw or restrictor may be installed in the gauge socket to reduce shock to the gauge and prevent wear on the movement, and should be installed where sudden pressure surges or oscillations are expected. Snubber screws reduce the pulsation by forcing the pressure medium through a porous metal core, while restrictors use a small orifice for pulsation reduction. Trerice also offers externally installed pressure snubbers. Please consult the Accessories section for details.

#### Snubber Screws and Restrictors

Optional Feature Code	Item No.	Service	Construction
SS2	D368	Air & other gases	316 stainless steel body & core, 1/4-20 UNC thread
SS4	D369	Vapor & low viscosity fluids under 30 SSU	316 stainless steel body & core, 1/4-20 UNC thread
SS6	D370	Water and oils 30 SSU to 250 SSU	316 stainless steel body & core, 1/4-20 UNC thread
SS8	D371	Heavy oils and viscous fluids 250 SSU to 500 SSU	316 stainless steel body, 1/4-20 UNC thread Core omitted, 0.040 orifice
RES	104-0005.3	Air, gases & fluids	Brass, push-in
RSS	Optional feature only. Not sold separately.	Air, gases & fluids	316L stainless steel, screw-in

Please consult the Option Application Table for snubber screw and restrictor availability.

### Alternate Fill Fluids (SLF & HLF)

By minimizing wear on the gauge internals resulting from vibration or oscillation, liquid filling can prolong the life of a pressure gauge. Liquid filling also acts a permanent lubricant to the moving parts of the instrument. Trerice provides glycerine as the standard fill material. Silicone (**SLF**) and halocarbon (**HLF**) are available as alternate fills. Please consult factory for availability.

### Recalibration and Certification

The factory is equipped to recalibrate and/or certify pressure gauges having  $\pm 0.5\%$  Full Scale ASME B40.100 Grade 2A or lesser accuracy in ranges from 30" Hg vacuum to 20,000 psi pressure. Price is determined by range, gauge accuracy and number of points certified; please consult factory.

# Optional Features

## OPTION AVAILABILITY TABLE

### Optional Feature Codes

	PLW	SGW	RSH	MAX	EC-X	WPC	PRP	SDM	CTB	SS-X	RES	RSS
	Plastic Window (Acrylic)	Laminated Safety Glass Window	Red Set Hand <sup>1</sup>	Maximum Registering Pointer <sup>2</sup>	Electric Contact <sup>3</sup>	Weather-Proofed Case	Pressure Relief Plug	Silicone Dampened Movement	Capillary Tube Bleeder	Snubber Screw	Push-in Restrictor	Restrictor Screw
450 Series (Dry)	S	O	O	O	O	S	N/A	O	N/A	O	N/A	N/A
450 Series Liquid Filled	S	O	O	N/A	O	S	N/A	N/A	N/A	O	N/A	N/A
500X Series	O	O	O	O	O	O	O	O	O	O	N/A	N/A
600 Series	O	N/A	O	N/A	N/A	O	O	O	N/A	N/A	O	N/A
690 Series	S	N/A	O	O	N/A	O	O	O	N/A	N/A	O	N/A
700 Series	O	S	N/A	O	O	S	S	O	N/A	N/A	N/A	O
750 Series	O	S	N/A	O	N/A	S	S	N/A	N/A	N/A	N/A	O

<sup>1</sup> Red set hand is not available with 1 1/2", 2", 8 1/2", or 12" dial size. Set hand per 2 1/2", dial size is an adhesive decal, applied directly to inside surface window.

<sup>2</sup> Maximum registering pointer not available on liquid filled gauges or 2 1/2", dial sizes.

<sup>3</sup> Electric contact only available with 4", 4 1/2", or 6" dial sizes. Consult factory for liquid filled gauge applications.

S – Standard Product Feature    O – Optional Feature at Additional Charge    N/A – Not Available

### How to Order

Specify the Optional Feature Ordering Code at the end of the Instrument Ordering Code.

Sample Order Number: **600CB 45 02 L A 110 PLW**