

BV2C and BV2N-Series - 2 Way, 3-Piece Sanitary Ball Valve

Features

- Live-loaded stem packing
- Precision stainless steel balls reduce torque and friction losses while extending seat life
- Integral ISO 5211 mounting pad
- I.D. polish is 32 Ra maximum
- Lockable handle can prevent accidental actuation
- Standard internal entry blowout-proof stem design
- Full port design matches ball and seat ports to tube I.D. for lower pressure drop and less turbulent flow
- Compact design for areas with tight space restrictions
- Identification tagging available
- Balanced construction minimizes cold flow

Materials

- Product contact material: CF8M stainless steel
- Seats: virgin PTFE, 15% glass reinforced PTFE (RTFE), 25% carbon reinforced PTFE, 50% stainless steel reinforced PTFE, and UHMW

Specifications

- Maximum pressure rating: 1/2" - 2" **1000 PSI WOG**, 2-1/2" - 4" **800 PSI WOG**
- For valve seat options, call Dixon Sanitary at 800.789.1718

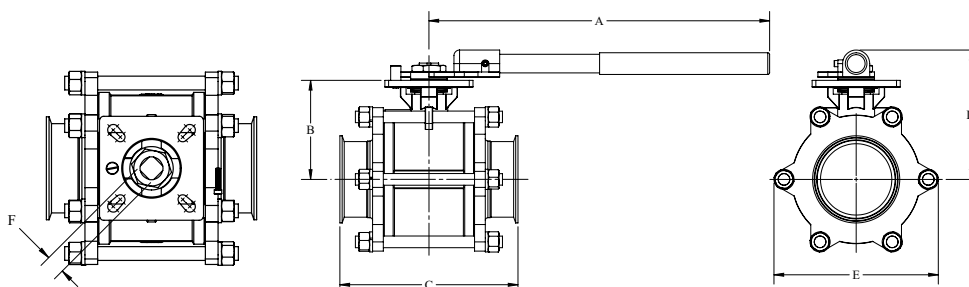

1/2" to 2"



2-1/2" to 4"

Size	Dimensions					
	A (in)	B (in)	C (in)	D (in)	E (in)	F (mm)
1/2"	4.9	1.5	4.3	3.0	1.9	9
3/4"	4.9	1.8	4.7	3.3	2.2	9
1"	5.6	2.1	4.9	3.6	2.4	11
1-1/2"	9.5	2.7	5.6	4.0	3.1	14
2"	9.5	3.1	6.4	4.8	3.7	14
2-1/2"	18.0	3.8	7.8	5.2	4.8	17
3"	18.0	4.2	9.0	5.7	5.4	17
4"	18.0	5.3	9.5	6.8	8.8	22

Size	Non-Encapsulated				
	316 Stainless Steel Virgin PTFE Part #	316 Stainless Steel RTFE Part #	316 Stainless Steel 25% Carbon PTFE Part #	316 Stainless Steel 50% SS PTFE Part #	316 Stainless Steel with UHMW Part #
1/2"	BV2NV-050CC-A	BV2NG-050CC-A	BV2NC-050CC-A	BV2NS-050CC-A	BV2NU-050CC-A
3/4"	BV2NV-075CC-A	BV2NG-075CC-A	BV2NC-075CC-A	BV2NS-075CC-A	BV2NU-075CC-A
1"	BV2NV-100CC-A	BV2NG-100CC-A	BV2NC-100CC-A	BV2NS-100CC-A	BV2NU-100CC-A
1-1/2"	BV2NV-150CC-A	BV2NG-150CC-A	BV2NC-150CC-A	BV2NS-150CC-A	BV2NU-150CC-A
2"	BV2NV-200CC-A	BV2NG-200CC-A	BV2NC-200CC-A	BV2NS-200CC-A	BV2NU-200CC-A
2-1/2"	BV2NV-250CC-A	BV2NG-250CC-A	BV2NC-250CC-A	BV2NS-250CC-A	BV2NU-250CC-A
3"	BV2NV-300CC-A	BV2NG-300CC-A	BV2NC-300CC-A	BV2NS-300CC-A	BV2NU-300CC-A
4"	BV2NV-400CC-A	BV2NG-400CC-A	BV2NC-400CC-A	BV2NS-400CC-A	BV2NU-400CC-A

Size	Encapsulated				
	316 Stainless Steel Virgin PTFE Part #	316 Stainless Steel RTFE Part #	316 Stainless Steel 25% Carbon PTFE Part #	316 Stainless Steel 50% SS PTFE Part #	316 Stainless Steel with UHMW Part #
1/2"	BV2CV-050CC-A	BV2CG-050CC-A	BV2CC-050CC-A	BV2CS-050CC-A	BV2CU-050CC-A
3/4"	BV2CV-075CC-A	BV2CG-075CC-A	BV2CC-075CC-A	BV2CS-075CC-A	BV2CU-075CC-A
1"	BV2CV-100CC-A	BV2CG-100CC-A	BV2CC-100CC-A	BV2CS-100CC-A	BV2CU-100CC-A
1-1/2"	BV2CV-150CC-A	BV2CG-150CC-A	BV2CC-150CC-A	BV2CS-150CC-A	BV2CU-150CC-A
2"	BV2CV-200CC-A	BV2CG-200CC-A	BV2CC-200CC-A	BV2CS-200CC-A	BV2CU-200CC-A
2-1/2"	BV2CV-250CC-A	BV2CG-250CC-A	BV2CC-250CC-A	BV2CS-250CC-A	BV2CU-250CC-A
3"	BV2CV-300CC-A	BV2CG-300CC-A	BV2CC-300CC-A	BV2CS-300CC-A	BV2CU-300CC-A
4"	BV2CV-400CC-A	BV2CG-400CC-A	BV2CC-400CC-A	BV2CS-400CC-A	BV2CU-400CC-A

BV2G-Series - Non-Encapsulated 2-Way, 3-Piece Sanitary Ball Valve



Features

- Blowout-proof stem
- Live-loaded stem packing
- I.D. polish is 32 Ra maximum
- Lockable handle
- No ISO 5211 mounting pad

Materials

- Product contact material: CF8M stainless steel
- Seats: 15% glass reinforced PTFE (RTFE)

Specifications

- Maximum pressure rating: 1/2" - 2" 1000 PSI WOG, 2-1/2" - 4" 800 PSI WOG
- Maximum temperature: 300°F (149°C)

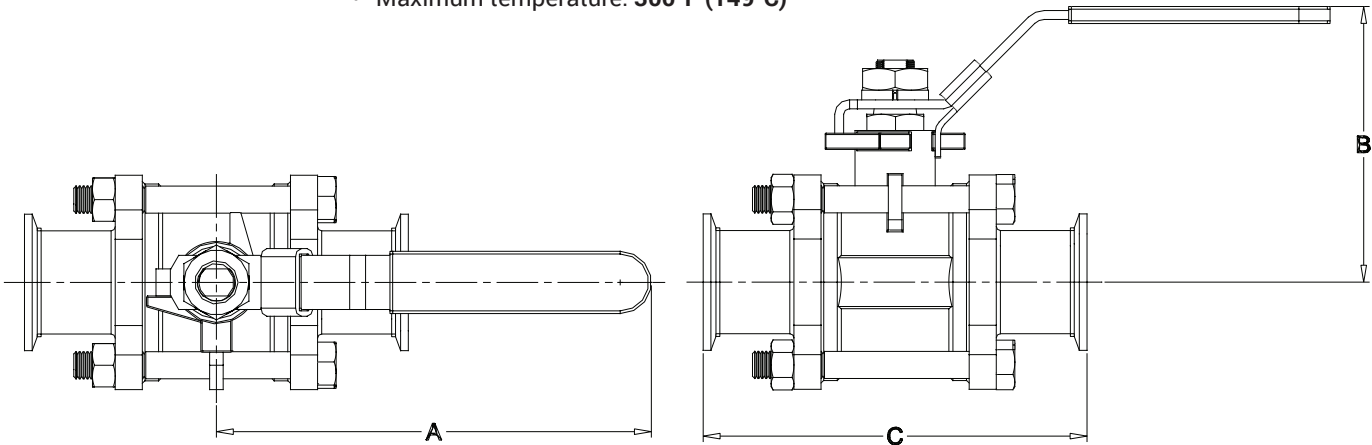

Size	Dimensions			316 Stainless Steel Part #
	A (in)	B (in)	C (in)	
1/2"	4.1	2.3	4.6	BV2GG-050CC-A
3/4"	4.1	2.5	4.7	BV2GG-075CC-A
1"	5.0	2.8	4.9	BV2GG-100CC-A
1-1/2"	6.1	3.5	5.6	BV2GG-150CC-A
2"	7.6	3.9	6.4	BV2GG-200CC-A
2-1/2"	7.6	4.4	7.8	BV2GG-250CC-A
3"	10.9	4.9	9.0	BV2GG-300CC-A
4"	13.2	6.6	9.6	BV2GG-400CC-A

Size	RTFE Repair Kit Part #
1/2"	BV-2G-GK050
3/4"	BV-2G-GK075
1"	BV-2G-GK100
1-1/2"	BV-2G-GK150
2"	BV-2G-GK200
2-1/2"	BV-2G-GK250
3"	BV-2G-GK300
4"	BV-2G-GK400

NOTE: Repair kit contains (2) seats, (2) body seals, (1) thrust washer, and (3) stem packing
Dimensions are approximate. Engineering dimensions are available upon request. Specifications are subject to change without notice.

Domestic Bronze Ball Valves

Application

- For control of air, water, oil, and gas in hose or pipe lines. For other services, please contact Dixon®

Features

- Blowout-proof stems
- Full and standard port valves are repairable

Materials

- Bronze valve bodies, balls, and stems
- Glass-filled reinforced PTFE seats and stuffing box ring; stem seals and washers
- Plated steel handles and nuts with vinyl sleeves. Replacements available, contact Dixon for pricing



Specification

- Pressure rating: **600 PSI CWP**; **150 PSI** saturated steam

Approval

- Meets WW-V 35C, Type II Composition

Female NPT	Port	Bronze Part #
1/4"	full	BBV25
3/8"		BBV38
1/2"		BBV50
3/4"		BBV75
1"	standard	BBV100
1-1/4"		BBV125
1-1/2"		BBV150
2"		BBV200
2-1/2"		BBV250
3"		BBV300

Domestic Full Port Bronze Ball Valves

Features

- Adjustable packing
- Blow-out proof stem design

Materials

- Machined solid chrome-plated ball
- Multi-fill RPTFE seats and seals

Specifications

- Vacuum service to 29 inches Hg
- Pressure rating: **600 PSI CWP**; **150 PSI** saturated steam



Female NPT	Port	Bronze Part #
3/4"	full	BBV75FP
1"		BBV100FP
1-1/4"		BBV125FP
1-1/2"		BBV150FP
2"		BBV200FP

Locking Handle Bronze Ball Valves

Application

- For control of air, water, oil, and gas in hose or pipe lines. For other services, please contact Dixon®

Features

- Blow-out proof RPTFE stem
- Full and standard port valves are repairable
- Vacuum service to 29 in Hg

Materials

- Chrome-plated bronze ball
- Stainless steel sliding lock mechanism secures handle in open or closed position; can be padlocked open or closed
- Plated steel handles and nuts with vinyl sleeves

Specification

- Pressure rating: **600 PSI CWP; 150 PSI** saturated steam

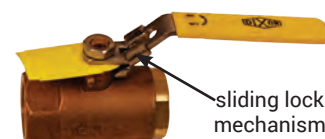

Female NPT	Port	Bronze Part #
1/4"	full	BBLV25
3/8"		BBLV38
1/2"		BBLV50
3/4"	standard	BBLV75
1"		BBLV100
1-1/4"		BBLV125
1-1/2"		BBLV150
2"		BBLV200

Bronze Ball Valves

Applications

- For air, water, oil, and gas service

Features

- Blow-out proof stem
- Adjustable packing gland
- Vacuum service to 29 in Hg

Materials

- Chromium plated ball
- RTFE seats and stuffing box ring

Specification

- Pressure rating: **600 PSI**
- Cold non-shock pressure rating: **150 PSI** saturated steam

Approvals

- MSS SP-110 - ball valves threaded, socket welding, solder joint, grooved and flared ends; CRN: OC10908.5C



Male NPT x Female NPT	Port	Bronze Part #
1/2"	standard	BMV50
3/4"	standard	BMV75
1"	standard	BMV100

"Deadman" Spring Return Handle Brass Ball Valves

Features

- Blow-out proof stem design
- Adjustable packing gland
- Spring return closes valve when not held open

Materials

- Stainless steel lever
- Chromium plated ball
- RTFE seats and stuffing box ring

Specification

- Operating torque approximately three times standard valve torque
- Pressure rating: **600 PSI CWP; 150 PSI** saturated steam
- Vacuum service to 29 inches Hg



Female NPT	Port	Brass Part #
1/2"	full	BBV50SR
3/4"	standard	BBV75SR
1"		BBV100SR
1-1/2"		BBV150SR
2"		BBV200SR

250 Lb. Steam Ball Valves



Application

- Recommended for use with fluids with widely varying temperatures and/or thermal expansion rates

Material

- 316 stainless steel ball and stem

Features

- Blow-out proof stem design
- Multi-fill RPTFE seats
- Multi-fill stuffing box ring
- High temperature MTFE stem packing
- Adjustable packing gland

Specifications

- Maximum temperature: **450°F (232°C)**
- Pressure rating: **600 PSI; 250 PSI** saturated steam
- Vacuum service to 29 inches Hg

Female NPT	Port	Bronze Part #
1/2"	full	BBV50ST
3/4"	standard	BBV75ST
1"		BBV100ST
2"		BBV200ST

Safety Vented Ball Valves

Application

- For air service only



Materials

- Chromium plated ball
- RTFE seats and stuffing box ring

Features

- Blow-out proof stem design
- Adjustable packing gland

Specification

- Pressure rating: **0-125 PSI**



sliding lock mechanism

Female NPT	Port	Bronze Part #
1/4"	full	BBV25LV
3/8"		BBV38LV
1/2"		BBV50LV
3/4"	standard	BBV75LV
1"		BBV100LV
1-1/4"		BBV125LV
1-1/2"		BBV150LV
2"		BBV200LV

NOTE: Valve closed and draining. Upstream seat stop air flow. Downstream system is vented to atmosphere.

Bronze Ball Valves with NPT Tap for Drain

Application

- Recommended for water and air service

Materials

- RTFE seats and stuffing box ring
- Chromium plated ball

Features

- Blow-out proof stem
- Adjustable packing gland
- Auto-drain / auto-vent
- 1/4" NPT tapped port provides additional options such as an air venting elbow or noise muffler

Specification

- Pressure rating: **125 PSI CWP**



Female NPT	Port	Bronze Part #
1/4"	full	BBV25VT
3/8"		BBV38VT
1/2"		BBV50VT
3/4"		BBV75VT
1"		BBV100VT

Imported Brass Ball Valves

Application

- For control of air, water, oil, and gas in hose or pipe lines, for other services, please contact Dixon®

Features

- Blow-out proof stems

Materials

- PTFE seat, seal and thrust washer
- Chrome-plated brass ball and plated steel handle

Specifications

- Maximum temperature: **366°F (186°C)**
- Pressure rating: **600 PSI WOG; 150 PSI Working Steam Pressure**

Approval

- UL listed

Female NPT x Female NPT



Size	Port	Forged Brass Part #
1/4"	full	FBV25
3/8"		FBV38
1/2"		FBV50
3/4"		FBV75
1"		FBV100
1-1/4"		FBV125
1-1/2"		FBV150
2"		FBV200



Female NPT x Female NPT



Size	Port	Forged Brass Part #
2-1/2"	full	FBV250
3"		FBV300
4"		FBV400

Imported Brass Ball Valves with Locking Handle

Application

- For control of air, water, oil and gas in hose or pipe lines, for other services please contact Dixon®

Features

- Blow-out proof stem

Materials

- PTFE seat, seal, and thrust washer
- Chrome-plated brass ball and plated steel handle

Specifications

- Maximum temperature: **366°F (186°C)**
- Pressure ratings: **600 PSI WOG; 150 PSI working steam pressure**

Female NPT	Port	Forged Brass Part #
1/2"	full	FBVL50
3/4"		FBVL75
1"		FBVL100
1-1/4"		FBVL125
1-1/2"		FBVL150
2"		FBVL200
2-1/2"		FBVL250
3"		FBVL300
4"		FBVL400



Global Brass Ball Valves

Application

- For water and air only



Specifications

- Pressure ratings
 - 1/4" - 3/8" rated to **365 PSI**
 - 1/2" - 2" rated to **600 PSI**
- Maximum temperature: **248°F (120°C)**



Female NPT	Port	Forged Brass Part #
1/4"	full	FBVG25
3/8"		FBVG38
1/2"		FBVG50
3/4"		FBVG75
1"		FBVG100
1-1/4"		FBVG125
1-1/2"		FBVG150
2"		FBVG200

Solder End Brass Ball Valves

Application

- Provides protection against potential gas leakage under extreme duty or low pressure applications

Materials

- Chrome-plated brass ball
- PTFE seat, seal, and thrust washer

Features

- Blow-out proof stem
- Adjustable stem packing nut

Specifications

- Pressure rating: **600 PSI WOG; 150 PSI** working steam pressure
- Maximum temperature: **366°F (186°C)**



Size	Port	Brass Part #
1/2"	full	FBV50SE
3/4"		FBV75SE
1"		FBV100SE
1-1/4"		FBV125SE
1-1/2"		FBV150SE
2"		FBV200SE

Lead-Free Brass Ball Valves

Feature

- PTFE seat and double O-ring stem packing

Specifications

- Pressure rating: **600 WOG - 150 WSP**
- Maximum temperature: **366°F (186°C)**

Approvals

- Lead-free refers to the wetted surface of pipes, fittings, and fixtures in potable water systems that have a weighted average lead content = 0.25% Source: California Health & Safety Code (116875). Vermont Act 193*171NLF



Female NPT	Port	Lead-Free Brass Part #
1/2"	full	LFV50
3/4"		LFV75
1"		LFV100
1-1/4"		LFV125
1-1/2"		LFV150
2"		LFV200

Dual Y Valves

Application

- Ideal for compressor applications

Feature

- Dual action valve

Specifications

- Non-vented pressure rating: **600 PSI CWP**
- Vented pressure rating: **125 PSI CWP**

Vented

Female NPT Inlet (1)	Female NPT Outlets (2)	Bronze Part #
1"	3/4"	BBV100DWV
1-1/4"		BBV125DWV

Non-Vented

Female NPT Inlet (1)	Female NPT Outlets (2)	Bronze Part #
1"	3/4"	BBV100DW
1-1/4"		BBV125DW



Mini Ball Valves

Feature

- Blow-out proof stem

Material

- PTFE seats and FKM stem seal

Specifications

- Maximum temperature **330°F (166°C)**
- Pressure rating: **450 PSI**

Approval

- Canadian Standard Association approved

Female NPT	Port	Nickel Plated Brass Part #
1/8"	standard	MBV12
1/4"		MBV25
3/8"		MBV38
1/2"		MBV50

Mini Brass Ball Valves

Application

- Water, oil or gas in commercial, and light industrial applications

Features

- Blow-out proof stem
- Large raised wrench flat
- Reversible handle
- Full port
- Ideal use for as a gas or gauge cock
- Threads: NPT

Materials

- Forged brass
- Seal: standard FKM
- Seat: TFE

Specifications

- PSI ratings: **600 PSI at 100°F (37°C)**
- Temperature rating: **-40°F to 300°F (-40°C to 148°C)**
- End configurations: female x female and male x female

Approvals

- ANSI Z21.15-2009/CSA 9.1-2009 (**1/2 PSI**)-manually operated gas valves for appliances
- ASME B1644-2002- manually operated metallic gas valves for use in above ground piping systems (**2 and 5 PSIG**)
- MSS SP-100 compliant
- CSA **1/2 PSI** and **5 PSI** gas listings

Size	Part #
1/4"	MBBV25
1/8"	MBBV12
1/4"	MBBMV25
1/8"	MBBMV12

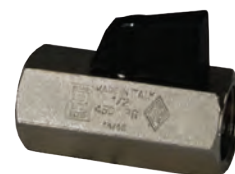

MBBMV25



MBBV25

3-Way Brass Diverting Ball Valves - T Flow
Female NPT x Female NPT x Female NPT

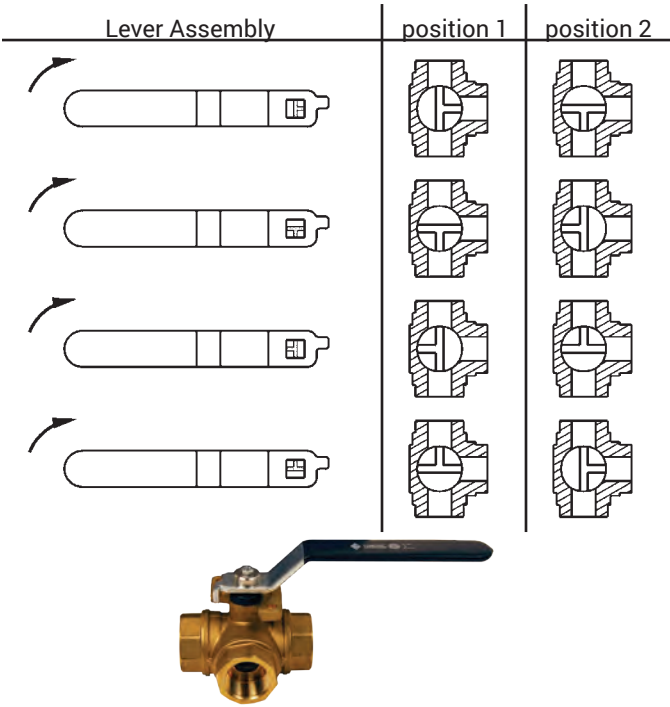

- Features**

 - Blow-out proof stem
 - Adjustable stem packing

Materials

 - Chrome plated brass ball
 - PTFE seats, seals, and thrust washer
- Specifications**

 - Maximum temperature: **366°F (186°C)**
 - Pressure rating: **400 PSI WOG; 100 PSI saturated steam**

Size	Port	Brass Part #
1/2"	standard	BBV50DTW
3/4"		BBV75DTW
1"		BBV100DTW
1-1/4"		BBV125DTW
1-1/2"		BBV150DTW
2"		BBV200DTW

NOTE: 1/4 turn handle can be adjusted to any orientation.
Notches on the valve stem reflect the three openings on the ball.

3-Way Diverting Ball Valves - L Flow
Female NPT x Female NPT x Female NPT

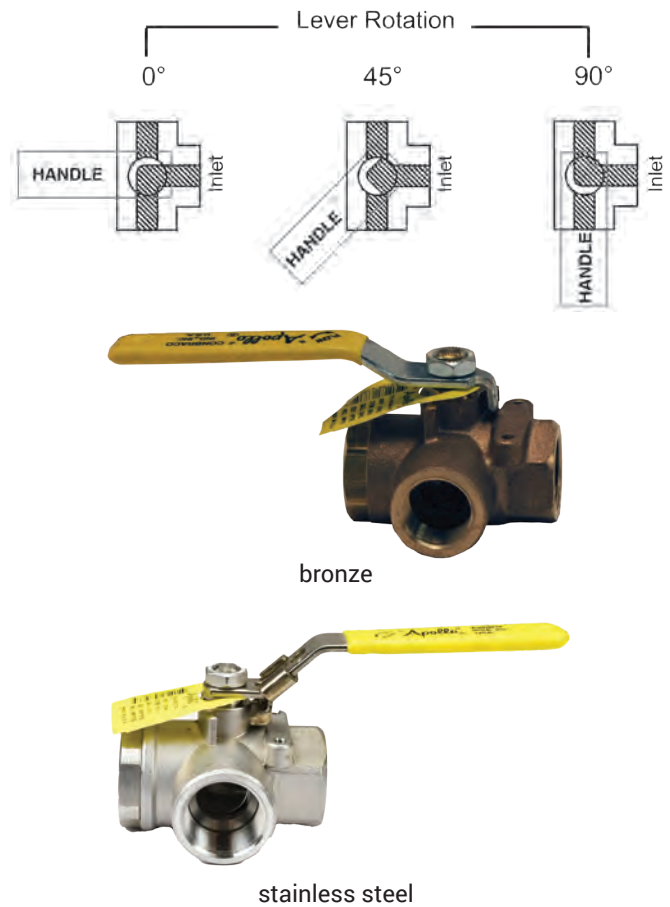

- Features**

 - Can be used with gasoline and diesel fuel
 - Blow-out proof stem
 - Adjustable packing gland

Materials

 - Chromium-plated ball
 - RPTFE seats and stuffing box ring
 - Stainless steel handle and nut with vinyl sleeve
- Specification**

 - Pressure rating: **400 PSI CWP**

Size	Port	Bronze Part #
1/2"	full	BBV50TW ¹
3/4"	standard	BBV75TW
1"		BBV100TW

¹ Carbon steel handle and nut with vinyl sleeve

- Features**

 - Blow-out proof stem
 - Adjustable packing gland
 - Locking handle

Materials

 - Stainless steel ball
 - RPTFE seats and stuffing box ring
 - Stainless steel handle and nut with vinyl sleeve
- Specification**

 - Rated to **800 PSI CWP**

Approval

 - Meets NACE MR0175

Size	Port	Stainless Steel Part #
1/2"	full	SSBV50TW
3/4"	standard	SSBV75TW
1"		SSBV100TW

2-Piece Domestic Stainless Steel Ball Valves

Feature

- Blow-out proof stem

Materials

- 316 stainless ball and stem
- RPTFE seal
- Vinyl handle cover

Specifications

- Temperature range: **-40°F to 400°F (-40°C to 204°C)**
- Pressure rating: **1,000 PSI CWP**
- Pressure rating: **150 PSI** saturated steam
- Vacuum service to 29 inches Hg

Female NPT	Port	316 Stainless Steel Part #
1/4"	full	DSBV25
3/8"		DSBV38
1/2"		DSBV50
3/4"		DSBV75
1"		DSBV100
1-1/4"		DSBV125
1-1/2"		DSBV150
2"		DSBV200

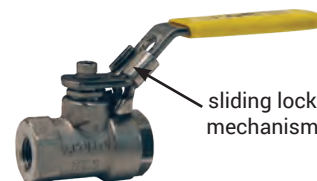

Stainless Steel Ball Valves Full Port

Applications

- For use with water, oil, and gas

Feature

- Blow-out proof stem design

Materials

- 316 stainless steel ball and stem
- RPTFE seat, joint gasket, and thrust washer

Specifications

- Temperature range:
-20°F to 428°F (-29°C to 220°C) as long as the valve is run fully open/closed
- Pressure rating:
rated to **1000 PSI WOG (CWP)**
100 PSI saturated steam

Female NPT	Port	316 Stainless Steel Part #
1/4"	full	SSBV25
3/8"		SSBV38
1/2"		SSBV50
3/4"		SSBV75
1"		SSBV100
1-1/4"		SSBV125
1-1/2"		SSBV150
2"		SSBV200
2-1/2"		SSBV250
3"		SSBV300



Full Port Ball Valves with Locking Handle

Applications

- For use with water, oil, and gas

Features

- Lockable
- Blow-out proof stem design
- Not recommended as a throttling valve

Materials

- 316 stainless steel ball and stem
- RPTFE seat, joint gasket and thrust washer
- Plastic cover on handle

Specifications

- Temperature range: -20°F to 428°F (-29°C to 220°C)
- Pressure rating: rated to 1000 PSI WOG (CWP)
100 PSI saturated steam

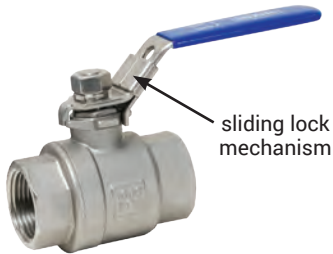

Female NPT	Port	316 Stainless Steel Part #
1/4"	full	SSLBV25
3/8"		SSLBV38
1/2"		SSLBV50
3/4"		SSLBV75
1"		SSLBV100
1-1/4"		SSLBV125
1-1/2"		SSLBV150
2"		SSLBV200
2-1/2"		SSLBV250
3"		SSLBV300

Reduced Port Ball Valves with Locking Handle

Applications

- For use with water, oil, and gas

Features

- Lockable
- Blow-out proof stem design
- Not recommended as a throttling valve

Materials

- 316 stainless steel ball and stem
- RPTFE seat, joint gasket, and thrust washer
- Plastic cover on handle

Specifications

- Temperature range: -20°F to 428°F (-29°C to 220°C)
- Pressure rating: 1000 PSI WOG; 100 PSI saturated steam

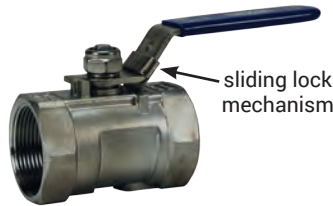

Female NPT	Port	316 Stainless Steel Part #
1/4"	reduced	SSLBV25SP
3/8"		SSLBV38SP
1/2"		SSLBV50SP
3/4"		SSLBV75SP
1"		SSLBV100SP
1-1/4"		SSLBV125SP
1-1/2"		SSLBV150SP
2"		SSLBV200SP

BV2I-Series 3-Piece Industrial Ball Valves

Features

- 3-piece full port design
- Blowout-proof stem
- Live-loaded stem packing
- Swing out design for easy maintenance
- ISO 5211 mounting pad
- RTFE seat and seals
- 25% carbon seat option available

Specifications

- Temperature: -20°F (-29°C) to 400°F (200°C)
- Maximum pressure: 1/4" - 1/2" 1,000 PSI WOG at 65°F (18°C), 2-1/2" - 3" 800 PSI WOG at 65°F (18°C), 4" 600 PSI WOG at 65°F (18°C)

Size	FNPT CF8M Stainless Steel Part #	Socket Weld CF8M Stainless Steel Part #
1/2"	BV2IGN05011-A	BV2IGN05033-A
3/4"	BV2IGN07511-A	BV2IGN07533-A
1"	BV2IGN10011-A	BV2IGN10033-A
1-1/4"	BV2IGN12511-A	BV2IGN12533-A
1-1/2"	BV2IGN15011-A	BV2IGN15033-A
2"	BV2IGN20011-A	BV2IGN20033-A
2-1/2"	BV2IGN25011-A	BV2IGN25033-A
3"	BV2IGN30011-A	BV2IGN30033-A
4"	BV2IGN40011-A	BV2IGN40033-A



FNPT



socket weld

Repair Kits for BV2I-Series Ball Valve

Size	Repair Kit Contains	BV2I-Series Ball Valves Repair Kit Part #
1/2"	(2) seats (1) thrust washer (2) stem packing (1) silicone O-ring	BV-2IN-GK050
3/4"		BV-2IN-GK075
1"		BV-2IN-GK100
1-1/4"		BV-2IN-GK125
1-1/2"		BV-2IN-GK150
2"		BV-2IN-GK200
2-1/2"		BV-2IN-GK250
3"		BV-2IN-GK300
4"		BV-2IN-GK400

"Deadman" Spring Return Handle Stainless Steel Ball Valves

Features

- PTFE seal
- Blow-out proof stem design
- Adjustable packing gland
- Spring return closes valve when not held open

Specifications

- Operating torque approximately three times standard valve torque
- Pressure rating: 2000 PSI WOG 1/2" to 1"; 1500 PSI WOG 1-1/4" to 2"
- 150 PSI saturated steam, all sizes
- Vacuum service to 29 inches Hg, all sizes

Female NPT	Port	316 Stainless Steel Part #
1/2"	full	SSBV50SR
3/4"	standard	SSBV75SR
1"		SSBV100SR
1-1/4"		SSBV125SR
1-1/2"		SSBV150SR
2"		SSBV200SR



Dixon® MannTek Full Flow Ball Valves

Features

- Two ports - one inlet and one outlet
- High flow rate; low pressure drop
- Spindle can be disassembled even when ball valve is installed
- Optional ports include DN flange, butt weld, and 150# flange; contact Dixon for details

Materials

- Wetted parts are aluminum and stainless steel
- FPM seals

Specifications

- Working pressure: **150 PSI** at ambient temperature **70°F (21°C)**
- Standard valve ports - female NPT, socket weld for Schedule 40 pipe and grooved



One-Way Full Flow Ball Valve Female NPT

Size	Aluminum Part #
2"	1WAYBV200
3"	1WAYBV300
4"	1WAYBV400



One-Way Full Flow Ball Valve Socket Weld

Size	Bore	Aluminum Part #
2"	2.390"	1WAYBV200SW
3"	3.530"	1WAYBV300SW

One-Way Full Flow Ball Valve Grooved

Size	Aluminum Part #
2"	1WAYBV200VIC
3"	1WAYBV300VIC



Dixon® MannTek Full Flow Ball Valves

Application

- Commonly used for switching compartments or tanks

Features

- High flow rate; low pressure drop
- Spindle can be disassembled even when ball valve is installed
- Optional ports include DN flange, butt weld, and 150# flange, contact Dixon for details
- Three ports - one inlet and two outlets, valve directs the flow from the inlet to either of the two outlets

Materials

- Wetted parts are aluminum and stainless steel
- FPM seals

Specifications

- Working pressure: **150 PSI** at ambient temperature **70°F (21°C)**
- Standard valve ports - female NPT, socket weld for Schedule 40 pipe and grooved

Two-Way Full Flow Ball Valve Female NPT

Size	Aluminum Part #
2"	2WAYBV200
	2WAYBV200-SH ¹
3"	2WAYBV300

¹ Supplied with straight handle

Two-Way Full Flow Ball Valve Socket Weld

Size	Bore	Aluminum Part #
2"	2.390"	2WAYBV200SW
		2WAYBV200SW-SH ¹
3"	3.530"	2WAYBV300SW

¹ Supplied with straight handle

Two-Way Full Flow Ball Valve Grooved

Size	Aluminum Part #
2"	2WAYBV200VIC3
3"	2WAYBV300VIC3

Carbon Steel Ball Valves

Applications

- For control of air, water, oil, and gas in hose or pipe lines, for other services please contact Dixon

Features

- Blow-out proof stem
- Adjustable packing gland

Materials

- Carbon steel body
- Chromium plated ball
- RPTFE seat and seal

Specification

- Pressure rating: **150 PSI** saturated steam

Female NPT	PSI	Port	Carbon Steel Part #
1/4"	2000	full	IBV25
3/8"	2000		IBV38
1/2"	2000	standard	IBV50
3/4"	2000		IBV75
1"	2000		IBV100
1-1/4"	1500		IBV125
1-1/2"	1500		IBV150
2"	1500		IBV200



2WAYBV200



2WAYBV200-SH



High Pressure Full-Bore 3-Way Ball Valves



Standard L 90°

Features

- Rugged construction
- Black oxide coating

Materials

- FKM seals
- POM (Polyacetal) ball seats
- Nickel plated ball

Specification

- Temperature range: -20°F to 215° F (-29°C to 102°C)

Female NPT	PSI	Carbon Steel Part #
1/2"	5145	HPBV12-3WAY
3/4"		HPBV34-3WAY
1"		HPBV10-3WAY

High Pressure Clear Zinc Ball Valves

Feature

- Full port, sizes 1/4 - 1", Reduced port, sizes 1-1/4 - 1-1/2"

Specification

- Temperature range: -20°F to 215°F (-29°C to 102°C)

Materials

- Nitrile rubber O-rings
- POM (Polyacetal) ball seats

Approval

- RoHS compliant



Female NPT	PSI	Carbon Steel		PSI
		Part #	SAE Part #	
1/4"	7350	HPBV25ZPL	HPBV25SAEZPL	7350
3/8"		HPBV38ZPL	HPBV38SAEZPL	
1/2"		HPBV12ZPL	HPBV12SAEZPL	
3/4"	6000	HPBV34ZPL	HPBV34SAEZPL	6000
1"		HPBV10ZPL	HPBV10SAEZPL	
1-1/4"		HPBV125ZPL	HPBV125SAEZPL	
1-1/2"		HPBV150ZPL	HPBV150SAEZPL	
2"		HPBV200ZPL	HPBV200SAEZPL	

High Pressure Full-Bore Ball Valves

Features

- Blow-out proof stem
- Rugged construction
- Full port, sizes 1/4 - 1", Reduced port, sizes 1-1/4 - 1-1/2"

Materials

- FKM/FPM seals
- POM (Polyacetal) ball seats
- Coating: black oxide



Female NPT	PSI	Carbon Steel		PSI	316 Stainless Steel Part #
		Part #	SAE Part #		
1/4"	7350	HPBV25	HPBV25SAE	5880	HPBV25SS
3/8"		HPBV38	HPBV38SAE		HPBV38SS
1/2"		HPBV12	HPBV12SAE		HPBV12SS
3/4"	6000	HPBV34	HPBV34SAE	5145	HPBV34SS
1"		HPBV10	HPBV10SAE		HPBV10SS
1-1/4"		HPBV125	HPBV125SAE	---	---
1-1/2"		HPBV150	HPBV150SAE	---	---
2"		HPBV200	HPBV200SAE	---	---

Polypropylene Compact Bolted Ball Valves

Materials

- Chemically-resistant, reinforced polypropylene body, PTFE ball seat
- EPDM O-ring body seal, FKM O-ring stem seals
- 304 stainless steel nuts and bolts

Specification

- Pressure rating: 125 PSI at 70°F (21°C)

Approval

- FDA approved material

Polypropylene Compact Bolted Ball Valve

Female NPT	Port	Body Length	Polypropylene Part #
2"	full	4-7/8"	PVFPS200

Polypropylene Compact Bolted Ball Valve

Female NPT x Male Adapter	Port	Body Length	Polypropylene Part #
2"	full	6-7/8"	PVFPSA200

Polypropylene 45° Single Union Nozzle Valves

Materials

- Corrosion resistant polypropylene body, PTFE ball seats
- EPDM O-ring

Specification

- Pressure rating: 125 PSI at 70°F (21°C)

Approval

- FDA approved material

Female NPT x Nozzle	Port	Polypropylene Part #
1"	full	SUBVN100

Polypropylene Bolted Ball Valves with Nozzle

Feature

- Body-to-flange design allows for low torque operation

Materials

- Chemically-resistant, reinforced polypropylene body, PTFE ball seat
- EPDM O-ring body seals, FKM O-ring stem seals
- 304 stainless steel nuts and bolts

Specification

- Pressure rating: 125 PSI at 70°F (21°C)

Approval

- FDA approved material

Female NPT x Nozzle	Port	Polypropylene Part #
1-1/2"	full	PVFPN150
2"		PVFPN200
2"	standard	PVN200

Polypropylene Single Union Ball Valves

Materials

- Corrosion resistant polypropylene body, PTFE ball seat
- EPDM O-ring

Specification

- Pressure rating: 125 PSI at 70°F (21°C)

Approval

- FDA approved material

Female NPT	Port	Polypropylene Part #
1/2"	full	SUBV50
3/4"		SUBV75
1"		SUBV100
1-1/4"		SUBV125
1-1/2"		SUBV150
2"		SUBV200
3"		SUBV300



0

